

Switch disconnectors

A modular and flexible range



Contact gap
7 mm
(norm >5.5 mm)

**Reversible
terminal feature**



► IN ENCLOSURE

- Degree of protection: up to IP 66
- For 25A to 100A size switches (see **the (A)** p. 316)
- Cable entries with pre-formed knockouts
- Tamper-proof cover with padlockable handle
- Recessed area for optional plate
- A wide choice of associated contact blocks and enclosures versions available

Pages 299 and 305

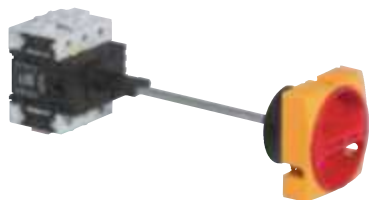

► WITH CLUTCH DRIVE

- Metal cuttable shafts
- With or without door interlock system
- Short or long metal shaft available

Pages 298 and 303

Complete switch disconnectors 20 A

IP 40 as standard, IP 65 on request

 Characteristics (p. 316)

▶ FRONT MOUNTING

PADLOCKABLE PRESENTATION

Cat. No.



172921

20 A - non-reversible terminals

| | |
|-------------|---------------|
| 3P | 172901 |
| 3P+NC/NO(1) | 172911 |
| 4P | 172921 |

(1) Padlock with \varnothing 6 to 8 mm

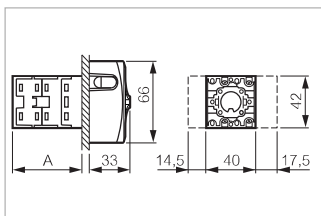

Dimensions

A: 46 (3P/4P)
56 (3P+NC/NO)

ACCESSORIES

Cat. No.



172945

IP65 seal kit

For front mounting with screws **172945**

Terminal covers

For front mounting with screws **172965**

Complete switch disconnectors 25 to 100 A

IP 40 as standard, IP 65 on request

 Characteristics (p. 316)

▶ FRONT MOUNTING

PADLOCKABLE PRESENTATION

Cat. No.

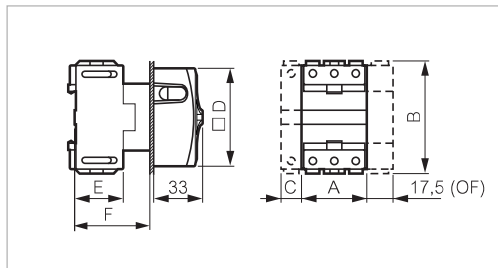

Safety switch to disconnect and isolate poles.
 IP 20 "finger safe"
 Double break type load switching
 Red padlockable handle on yellow plate
 Actual position (ON or OFF) clearly visible
 Conform to standards:
 IEC EN 60947-3
 Approved by UL - cUL – Suitable as motor disconnect



172001

| Dimensions | |
|------------|------|
| A: | 44 |
| B: | 75.4 |
| C: | 14.5 |
| D: | □ 66 |
| E: | 36 |
| F: | 50 |

25 A
 3P **172001**
 3P+NC/NO (1) **172011**
 4P neutral on left **172021**



172201

| Dimensions | |
|------------|------|
| A: | 53.6 |
| B: | 85 |
| C: | 17.9 |
| D: | □ 66 |
| E: | 50.3 |
| F: | 60 |

32 A
 3P **172101**
 4P neutral on left **172121**



172401

| Dimensions | |
|------------|------|
| A: | 71.8 |
| B: | 93 |
| C: | 26.8 |
| D: | □ 86 |
| E: | 63.8 |
| F: | 70 |

50 A
 3P **172201**
 4P neutral on left **172221**

63 A
 3P **172301**
 4P neutral on left **172321**

80 A
 3P **172401**
 4P neutral on left **172421**

100 A
 3P **172501**

(1) Padlock: ø 6 to 8 mm

Complete switch disconnectors 25 to 100 A

IP 40 as standard, IP 65 on request

 Characteristics (p. 316)

▶ FRONT MOUNTING

WITH PLATE, FRAME AND HANDLE

Cat. No.

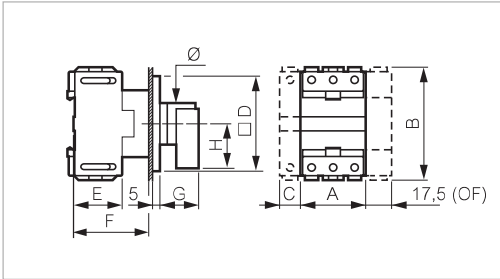

Safety switch to disconnect and isolate poles.
 IP 20 "finger safe"
 Double break type load switching
 Red handle on yellow plate
 Actual position (ON or OFF) clearly visible
 Conform to standards:
 IEC EN 60947-3
 Approved by UL - cUL – Suitable as motor disconnect



172002

| Dimensions | |
|------------|------|
| A: | 44 |
| B: | 75.4 |
| C: | 14.5 |
| D: | □ 64 |
| E: | 36 |
| F: | 50 |
| G: | 26 |
| H: | 22 |
| Ø: | 28 |

25 A
 3P 172002



172202

| Dimensions | |
|------------|------|
| A: | 53.6 |
| B: | 85 |
| C: | 17.9 |
| D: | □ 72 |
| E: | 50.3 |
| F: | 60 |
| G: | 26 |
| H: | 30 |
| Ø: | 28 |

32 A
 3P 172102



172402

| Dimensions | |
|------------|------|
| A: | 71.8 |
| B: | 93 |
| C: | 26.8 |
| D: | □ 96 |
| E: | 63.8 |
| F: | 70 |
| G: | 31 |
| H: | 34 |
| Ø: | 42 |

50 A
 3P 172202

63 A
 3P 172302

80 A
 3P 172402

100 A
 3P 172502

Complete switch disconnectors 25 to 100 A

IP 65

 Characteristics (p. 316)

► FRONT MOUNTING

PADLOCKABLE PRESENTATION Ø 22 SINGLE-HOLE MOUNTING

Cat. No.

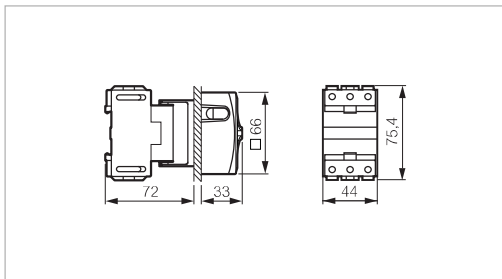

Safety switch to disconnect and isolate poles.
 IP 20 "finger safe"
 Double break type load switching
 Red handle on yellow plate
 Actual position (ON or OFF) clearly visible
 Conform to standards:
 IEC EN 60947-3
 Approved by UL - cUL – Suitable as motor disconnect



172003

| | |
|-------------|---------------|
| 25 A | |
| 3P | 172003 |
| 32 A | |
| 3P | 172103 |

Complete switch disconnectors 25 to 100 A

IP 40 as standard, IP 65 on request

 Characteristics (p. 316)

► REAR MOUNTING WITH CLUTCH DRIVE

PADLOCKABLE PRESENTATION

Cat. No.

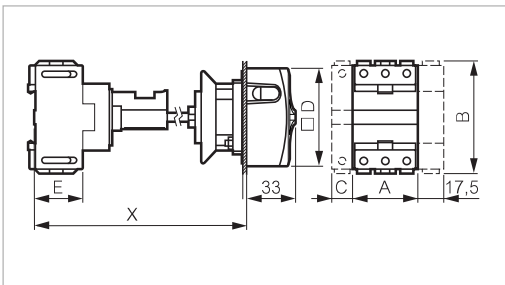

Safety switch to disconnect and isolate poles.
 IP 20 "finger safe"
 With clutch drive and door interlock
 Double break type load switching
 Red handle on yellow plate
 Actual position (ON or OFF) clearly visible
 Conform to standards:
 IEC EN 60947-3
 Approved by UL - cUL – Suitable as motor disconnect

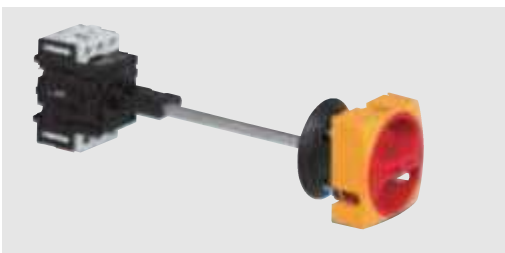

165009

| 25 and 32 A dimensions | |
|------------------------|---|
| A: | 44 |
| B: | 75.4 |
| C: | 14.5 |
| D: | □ 66 |
| E: | 31.5 |
| X: | 125 to 250 (short shaft) 250 to 400 (long shaft) |

| 50 and 63 A dimensions | |
|------------------------|---|
| A: | 53.6 |
| B: | 85 |
| C: | 17.9 |
| D: | □ 66 |
| E: | 42.2 |
| X: | 135 to 260 (short shaft) 260 to 410 (long shaft) |

| | |
|------------------|---------------|
| 25 A | |
| 3P (short shaft) | 165009 |
| 32 A | |
| 3P (short shaft) | 165109 |

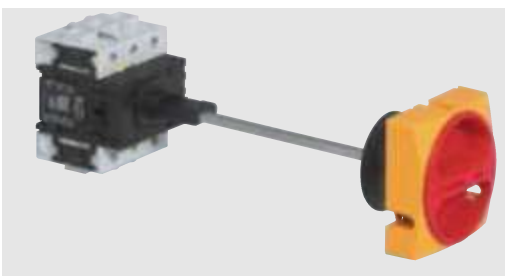

165409

| 80 and 100 A dimensions | |
|-------------------------|---|
| A: | 71.8 |
| B: | 93 |
| C: | 26.8 |
| D: | □ 86 |
| E: | 52.6 |
| X: | 145 to 270 (short shaft) 270 to 420 (long shaft) |

| | |
|------------------|---------------|
| 50 A | |
| 3P (short shaft) | 165209 |
| 63 A | |
| 3P (short shaft) | 165309 |
| 80 A | |
| 3P (long shaft) | 165409 |
| 100 A | |
| 3P (long shaft) | 165509 |

Complete switch disconnectors 25 to 100 A

IP 40 as standard, IP 65 on request
and IP 66 on enclosure version with integral handle version

 Characteristics (p. 316)

► ENCLOSURES

INTEGRAL PADLOCKABLE PRESENTATION

Cat. No.

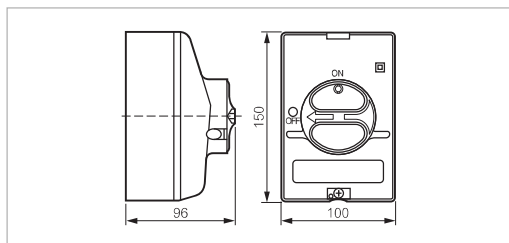

172061

Safety switch to disconnect and isolate poles.
IP 20 “finger safe”
With clutch drive and door interlock
Double break type load switching
Red handle on yellow plate
Actual position (ON or OFF) clearly visible
Conform to standards:
IEC EN 60947-3

IP 66 - IK 07

20 A

| | |
|-------------------------|---------------|
| 3P | 172961 |
| 3P+NC/NO ⁽¹⁾ | 172971 |
| 4P | 172981 |

25 A

| | |
|-------------------------|---------------|
| 3P | 172061 |
| 3P+NC/NO ⁽¹⁾ | 172071 |

32 A

| | |
|----|---------------|
| 3P | 172161 |
|----|---------------|

PADLOCKABLE PRESENTATION

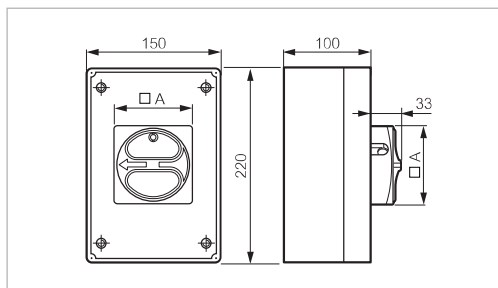

172261

50 and 63 A dimensions

A: 66

80 and 100 A dimensions

A: 86

IP 40 ⁽²⁾

50 A

| | |
|----|---------------|
| 3P | 172261 |
|----|---------------|

63 A

| | |
|----|---------------|
| 3P | 172361 |
|----|---------------|

80 A

| | |
|----|---------------|
| 3P | 172461 |
|----|---------------|

100 A

| | |
|----|---------------|
| 3P | 172561 |
|----|---------------|

(1) Padlock: Ø 6 to 8 mm
(2) IP 65 seal kit ref. 172267 (50 to 63 A)
172277 (80 to 100 A)

Complete switch disconnectors 20 A

IP 40 as standard, IP 65 on request
Grey presentation

 Characteristics (p. 316)

▶ FRONT MOUNTING

PADLOCKABLE PRESENTATION

Cat. No.



174901

20 A - non-reversible terminals

3P

174901

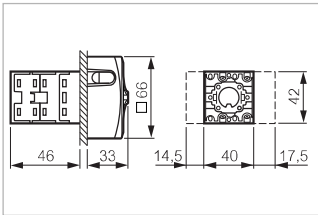

ACCESSORIES

Cat. No.



172945

IP 65 seal kit

For front mounting with screws

172945

Terminal covers

For front mounting with screws

172965

Complete switch disconnectors 25 to 100 A

IP 40 as standard, IP 65 on request
Grey presentation

 Characteristics (p. 316)

▶ FRONT MOUNTING

PADLOCKABLE PRESENTATION

Cat. No.

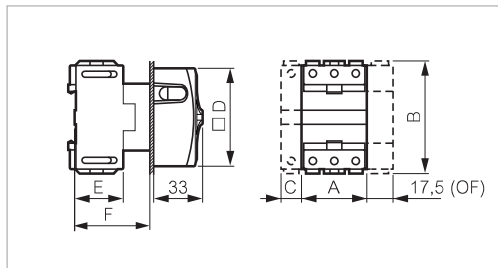

Safety switch to disconnect and isolate poles.
IP 20 "finger safe"
Double break type load switching
Grey padlockable handle on grey plate
Actual position (ON or OFF) clearly visible
Conform to standards:
IEC EN 60947-3
Approved by UL - cUL – Suitable as motor disconnect



174001

Dimensions

A: 44
B: 75.4
C: 14.5
D: □ 66
E: 36
F: 50

25 A

3P

174001

32 A

3P

174101



174301

Dimensions

A: 53.6
B: 85
C: 17.9
D: □ 66
E: 50.3
F: 60

50 A

3P

174201

63 A

3P

174301



174401

Dimensions

A: 71.8
B: 93
C: 26.8
D: □ 86
E: 63.8
F: 70

80 A

3P

174401

100 A

3P

174501

(1) Padlock: ϕ 6 to 8 mm

Complete switch disconnectors 25 to 100 A

IP 40 as standard, IP 65 on request
Grey presentation

 Characteristics (p. 316)

▶ FRONT MOUNTING

WITH PLATE, FRAME AND HANDLE

Cat. No.

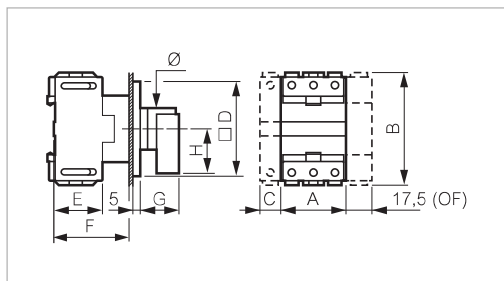

Safety switch to disconnect and isolate poles.
IP 20 “finger safe”
Double break type load switching
Black handle on aluminium plate
Actual position (ON or OFF) clearly visible
Conform to standards:
IEC EN 60947-3
UL - cUL approved – Suitable as motor disconnect



Dimensions

A: 44
B: 75.4
C: 14.5
D: □ 64
E: 36
F: 50
G: 26
H: 22
Ø: 28

25 A

3P

174002

32 A

3P

174102

174002



Dimensions

A: 53.6
B: 85
C: 17.9
D: □ 72
E: 50.3
F: 60
G: 26
H: 30
Ø: 28

50 A

3P

174202

63 A

3P

174302

174202



Dimensions

A: 71.8
B: 93
C: 26.8
D: □ 96
E: 63.8
F: 70
G: 31
H: 34
Ø: 42

80 A

3P

174402

100 A

3P

174502

174402

Complete switch disconnectors 25 to 100 A

IP 40 as standard, IP 65 on request
Grey presentation

 Characteristics (p. 316)

► REAR MOUNTING

PADLOCKABLE PRESENTATION

Cat. No.

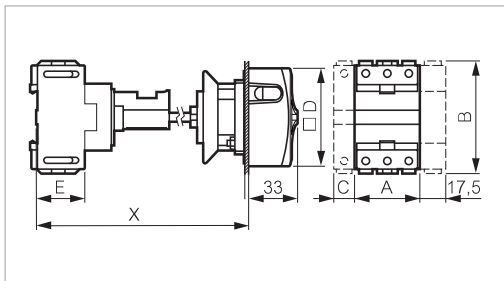

Safety switch to disconnect and isolate poles.
IP 20 “finger safe”
With clutch drive and door interlock
Double break type load switching
Grey padlockable handle on grey plate
Actual position (ON or OFF) clearly visible
Conform to standards:
IEC EN 60947-3
Approved by UL - cUL – Suitable as motor disconnect



165009

25 and 32 A dimensions

- A: 44
- B: 75.4
- C: 14.5
- D: □ 66
- E: 31.5
- X: 125 to 250 (short shaft)
250 to 400 (long shaft)

50 and 63 A dimensions

- A: 53.6
- B: 85
- C: 17.9
- D: □ 66
- E: 42.2
- X: 135 to 260 (short shaft)
260 to 410 (long shaft)

25 A
3P (short shaft) **168009**

32A
3P (short shaft) **168109**

50 A
3P (short shaft) **168209**

63 A
3P (short shaft) **168309**

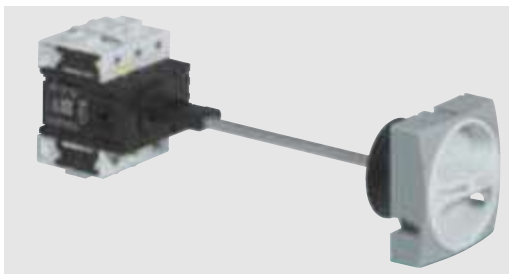

165409

80 and 100 A dimensions

- A: 71.8
- B: 93
- C: 26.8
- D: □ 86
- E: 42.6
- X: 145 to 270 (short shaft)
270 to 420 (long shaft)

80 A
3P (long shaft) **168409**

100 A
3P (long shaft) **168509**

Complete switch disconnectors 25 to 100 A

IP 40 as standard, IP 65 on request
Grey presentation

 Characteristics (p. 316)

► REAR MOUNTING

MODULAR IN-PANEL PRESENTATION

Cat. No.

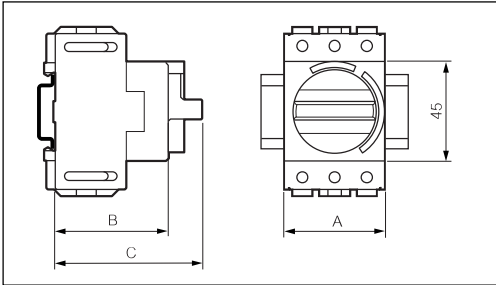

Safety switch to disconnect and isolate poles.
IP 20 "finger safe"
Double break type load switching
Black handle on grey plate
Actual position (ON or OFF) clearly visible
Conform to standards:
IEC EN 60947-3
Approved by UL - cUL – Suitable as motor disconnect



174005

| Dimensions | |
|------------|----|
| A: | 44 |
| B: | 53 |
| C: | 79 |

25 A
3P **174005**



174205

| Dimensions | |
|------------|------|
| A: | 53.6 |
| B: | 63 |
| C: | 89 |

32 A
3P **174105**



174405

| Dimensions | |
|------------|------|
| A: | 71.8 |
| B: | 73 |
| C: | 99 |

50 A
3P **174205**

63 A
3P **174305**

80 A
3P **174405**

100 A
3P **174505**

Complete switch disconnectors 25 to 100 A

IP 40 as standard, IP 65 on request and
IP66 on enclosure version with integral handle version
Grey presentation

 Characteristics (p. 316)

► ENCLOSURES

INTEGRAL PADLOCKABLE PRESENTATION

Cat. No.

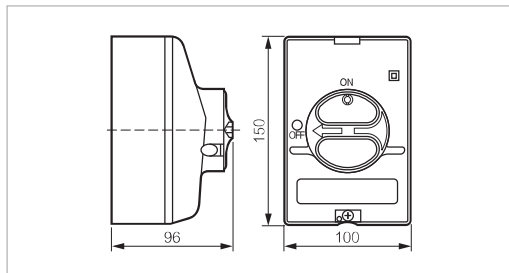

Safety switch to disconnect and isolate poles.
IP 20 “finger safe”
With clutch drive and door interlock
Double break type load switching
Grey padlockable handle
Actual position (ON or OFF) clearly visible
Conform to standards:
IEC EN 60947-3



174061

IP 66 - IK 07

25 A
3P

174061

32 A
3P

174161

PADLOCKABLE PRESENTATION

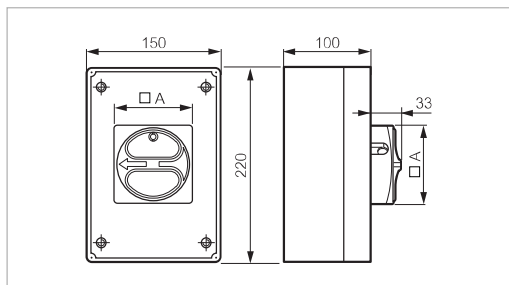

IP 40 (1)

50 A
3P

174261

63 A
3P

174361



174261

50 and 63 A dimensions

A: □ 66

80 and 100 A dimensions

A: □ 86

80 A
3P

174461

100 A
3P

174561

(1) IP 65 with seal ref. 172267 (50 to 63 A)
172277 (80 to 100 A)

Separate switch disconnectors - 25 and 32 A

 Characteristics (p. 316)

► BLOCKS

Cat. No.



172000

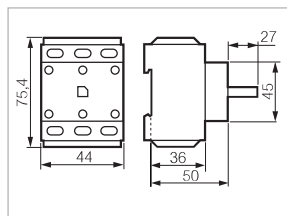

3-pole switch body without presentation

25 A
32 A

172000
172100



172065

172185

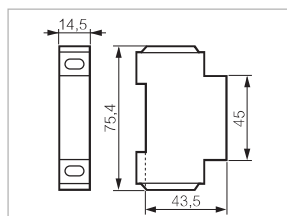

Additional pole
(for use in enclosure only)

25 A
32 A

172075
172175

Additional pole without rear screw
(Rear mounting only)

32 A

172174

Neutral pole

25 A
32 A

172065
172165



172179

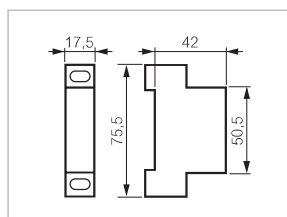

Junction block

 or N

172185

Auxiliary contact

NC/NO

172179

1 pole early break

172195



172195

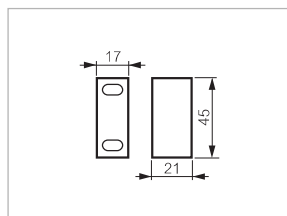

Separate switch disconnectors - 25 and 32 A

 Characteristics (p. 316)

PRESENTATION

Cat. No.

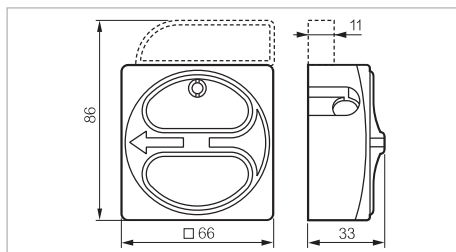

Padlockable presentation

Padlock with $\varnothing 6$ to 8 mm

- 66 - Yellow/Red
- 66 - Grey
- 66 - $\varnothing 22$ single-hole-mounting - Yellow/Red

172601
174601
172603

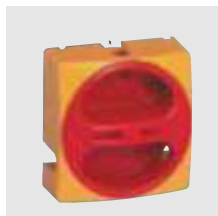

172601

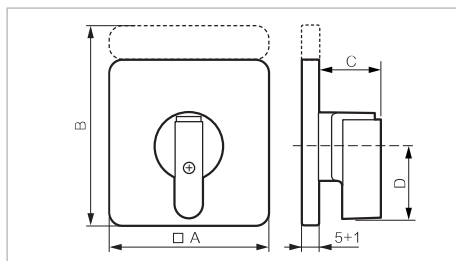

With plate, frame and handle

- 64 - Yellow/Red
- 48 - $\varnothing 22$ single-hole-mounting - Yellow/Red

172602
172604



172602

Dim. Ref. 172 602

A: $\square 64$
B: 80

Dim. ref. 172 604

A: $\square 48$
B: 65

Separate switch disconnectors - 25 and 32 A

 Characteristics (p. 316)

▶ EMPTY ENCLOSURES

PADLOCKABLE PRESENTATION

Cat. No.



172399

Dimensions 150 x 100 x 96 mm
 Supplied with padlockable handle,
 weatherproof seal and relay terminal
 For 3 and 4-pole switches
 with and without NC/NO

IP66-IKo7

Grey base - yellow cover - red handle
 Grey base - grey cover - grey handle

172399
174399

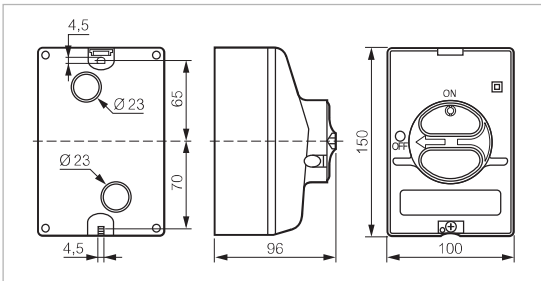

WITHOUT PRESENTATION

Cat. No.



172549

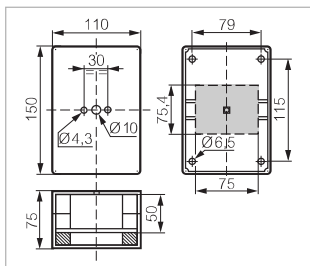

Grey - Up to 4 poles + auxiliary contact
 150 x 110 x 75 mm

172549

PADLOCKABLE OR WITHOUT PRESENTATION

Cat. No.



172559

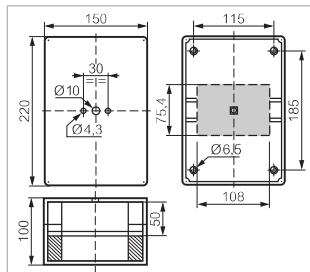

Grey - Up to 6 poles + auxiliary contact
 220 x 150 x 100 mm

172559

Separate switch disconnectors - 25 and 32 A

 Characteristics (p. 316)

▶ ACCESSORIES

Cat. No.



172167

Terminal covers

| | |
|---|---------------|
| For 3-pole body switch | 172167 |
| For additional pole, neutral pole or junction block | 172177 |
| For auxiliary contact NC/NO (pair) | 172189 |
| For early break auxiliary contact | 172199 |



174569

Connection terminal kit

| | |
|---|---------------|
| Terminal connection for ground or neutral | 174449 |
|---|---------------|



174189

Self-adhesive plates (for enclosures)

| | |
|--------------------------|---------------|
| Blank | 174599 |
| Engraved INTER PRINCIPAL | 174559 |
| Engraved MAIN SWITCH | 174569 |



172177

Duty labels

| | |
|--------------------------|---------------|
| Blank | 172629 |
| Engraved INTER PRINCIPAL | 172639 |
| Engraved MAIN SWITCH | 172649 |

Kit for clutch drive presentation

| | |
|--|---------------|
| Short shaft without door interlock | 174189 |
| Long shaft without door interlock | 174199 |
| Without shaft and without door interlock | 174179 |

Kit for door interlock

174249

IP 65 seal kit

For front mounting switches and enclosures

| | |
|--|---------------|
| Padlockable <input type="checkbox"/> 66 or plate and frame <input type="checkbox"/> 64 or <input type="checkbox"/> 72 | 172267 |
| Padlockable <input type="checkbox"/> 86 or plate and frame <input type="checkbox"/> 96 | 172277 |

For rear mounting switches with clutch drive

| | |
|--|---------------|
| Padlockable <input type="checkbox"/> 66 or plate and frame <input type="checkbox"/> 64 or <input type="checkbox"/> 72 | 174259 |
| Padlockable <input type="checkbox"/> 86 or plate and frame <input type="checkbox"/> 96 | 174269 |

Separate switch disconnectors - 50 and 63 A

 Characteristics (p. 316)

► BLOCKS

Cat. No.

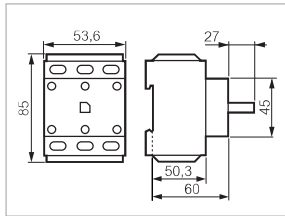

3-pole body switch without presentation

50 A
63 A

172200
172300

172300

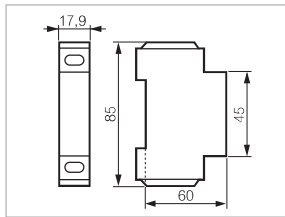

Additional pole
(for use in enclosure only)

50 A
63 A

172275
172375

172375

172385

Neutral pole

50 A
63 A

172265
172365

Junction block

 or N

172385

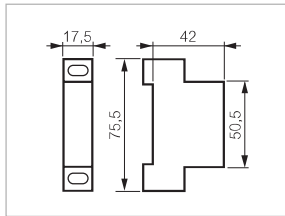

Auxiliary contact

NC/NO

172179

1 pole early break

172395

172179

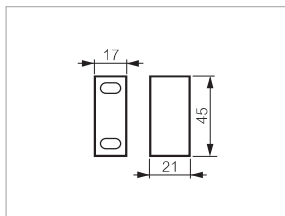

172395

Separate switch disconnectors - 50 and 63 A

 Characteristics (p. 316)

► PRESENTATION

Cat. No.



172061

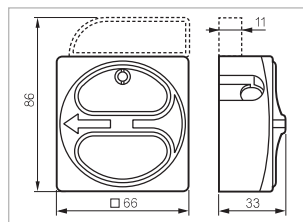

Padlockable presentation

Padlock: \varnothing 6 to 8 mm

- 66 - Yellow/Red
- 66 - Grey

172601
174601



172612

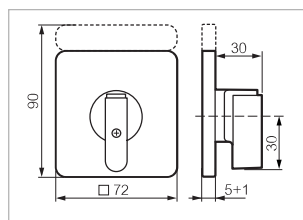

With plate, frame and handle

- 72 - Yellow/Red

172612

► EMPTY ENCLOSURES

WITHOUT PRESENTATION

Cat. No.



172569

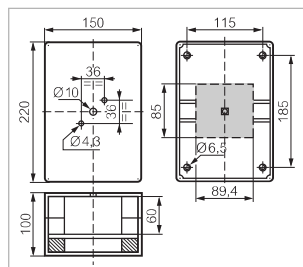

Grey - Up to 4 poles + auxiliary contact
220 x 150 x 100 mm

172569



172579

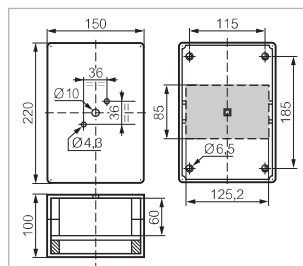

Grey - Up to 6 poles + auxiliary contact
220 x 150 x 100 mm

172579

Separate switch disconnectors - 50 and 63 A

 Characteristics (p. 316)

▶ ACCESSORIES

Cat. No.



172367

Terminal covers

| | |
|---|---------------|
| For 3-pole switch | 172367 |
| For additional pole, neutral pole or junction block | 172377 |
| For NC/NO auxiliary contact (pair) | 172189 |
| For early break auxiliary contact | 172199 |



172649

Duty labels

| | |
|--------------------------|---------------|
| Blank | 172629 |
| Engraved INTER PRINCIPAL | 172639 |
| Engraved MAIN SWITCH | 172649 |



172267

Kit for clutch drive presentation

| | |
|--|---------------|
| Short shaft without door interlock | 174189 |
| Long shaft without door interlock | 174199 |
| Without shaft and without door interlock | 174179 |

kit for door interlock

174249

IP 65 seal kit

For front mounting switches and enclosures

| | |
|---------------------------------|---------------|
| Padlockable □ 66 | 172267 |
| or plate and frame □ 64 or □ 72 | |
| Padlockable □ 86 | 172277 |
| or plate and frame □ 96 | |

For rear mounting with clutch drive

| | |
|---------------------------------|---------------|
| Padlockable □ 66 | 174259 |
| or plate and frame □ 64 or □ 72 | |
| Padlockable □ 86 | 174269 |
| or plate and frame □ 96 | |

Separate switch disconnectors - 80 and 100 A

 Characteristics (p. 316)

► BLOCKS

Cat. No.



172400

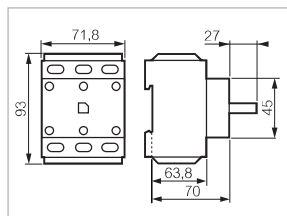

3-pole body switch without presentation

80 A
100 A

172400
172500



172475



172465

Additional pole
(for use in enclosure only)

80 A
100 A

172475
172575

Neutral pole

80 A
100 A

172465
172565



172585

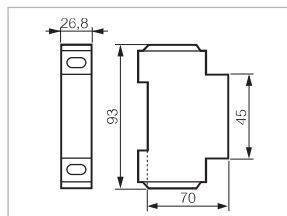

Junction block

 or N

172585



172179

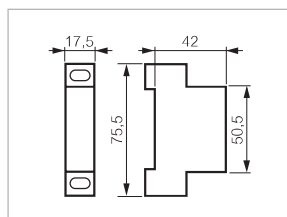

Auxiliary contact

NC/NO

1 pole early break

172179

172595



172595

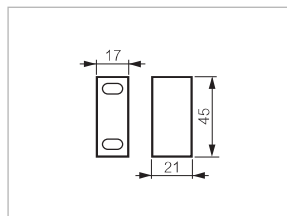

Separate switch disconnectors - 80 and 100 A

 Characteristics (p. 316)

PRESENTATION

Cat. No.



172621

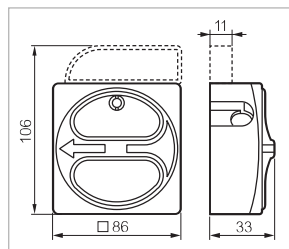

Padlockable presentation

Padlock: \varnothing 6 to 8 mm

- 86 - Yellow/Red
- 86 - Grey

172621
174621

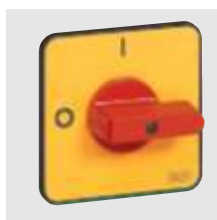

172622

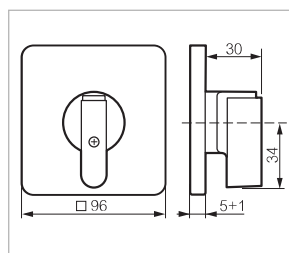

With plate, frame and handle

- 96 - Yellow/Red

172622

EMPTY ENCLOSURES

WITHOUT PRESENTATION

Cat. No.



172589

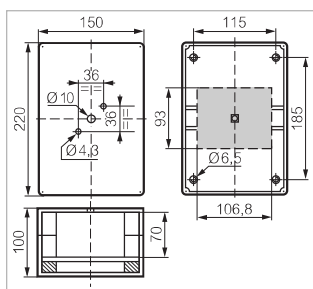

Grey - Up to 3 poles + auxiliary contact
220 x 150 x 100 mm

172589



172599

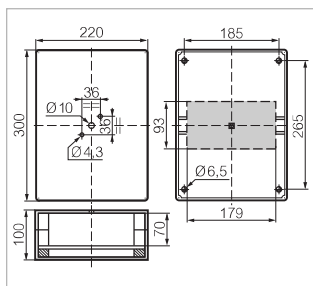



Grey - Up to 6 poles + auxiliary contact
300 x 200 x 100 mm

172599

Separate switch disconnectors - 80 and 100 A

 Characteristics (p. 316)

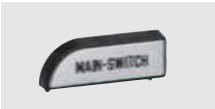
▶ ACCESSORIES

| | | Cat. No. |
|--|---|---------------|
|  172567 | Terminal covers | |
| | For 3-pole body switch | 172567 |
| | For additional pole, neutral pole or junction block | 172577 |
| | For NC/NO auxiliary contact (pair) | 172189 |
| | For early break auxiliary contact | 172199 |
|  172649 | Duty labels | |
| | Blank | 172629 |
| | Engraved INTER PRINCIPAL | 172639 |
| | Engraved MAIN SWITCH | 172649 |
|  172267 | Kit for clutch drive presentation | |
| | Short shaft without door interlock | 174189 |
| | Long shaft without door interlock | 174199 |
| | Without shaft and without door interlock | 174179 |
| | kit for door interlock | 174249 |
| | IP 65 seal kit | |
| | For front mounting switches and enclosures | |
| | Padlockable □ 66 or plate and frame □ 64 or □ 72 | 172267 |
| | Padlockable □ 86 or plate and frame □ 96 | 172277 |
| | For rear mounting with clutch drive | |
| | Padlockable □ 66 or plate and frame □ 64 or □ 72 | 174259 |
| | Padlockable □ 86 or plate and frame □ 96 | 174269 |

Technical characteristics

► GENERAL

| Characteristics | 20 A | 25 A | 32 A | 50 A | 63 A | 80 A | 100 A |
|---|---|--------|--------|--------|--------|--------|--------|
| ► Rated insulation voltage U_i (V) | 690 | 690 | 690 | 690 | 690 | 690 | 690 |
| ► Conventional free air thermal current I_{th} | | | | | | | |
| Uninterrupted rated current I_u (A) | 20 | 25 | 32 | 50 | 63 | 80 | 100 |
| ► Conventional enclosed thermal current I_{the} (A) | 16 | 20 | 25 | 40 | 50 | 63 | 80 |
| ► Rated impulse withstand voltage (overvoltage category III - pollution degree 3) U_{imp} (kV) | 4 | 6 | 6 | 6 | 6 | 6 | 6 |
| ► Rated operating current I_e (A) AC - 21 A/22 A Conform to IEC 60947-3 | 16 | 25 | 32 | 50 | 63 | 80 | 100 |
| ► Rated operating power (kW) | | | | | | | |
| AC 23 A 3 x 230 V | 4 | 5.5 | 5.5 | 15 | 15 | 18.5 | 22 |
| 3 x 400 V | 7.5 | 7.5 | 11 | 18.5 | 22 | 30 | 37 |
| 3 x 500 V | 5.5 | 7.5 | 11 | 22 | 30 | 37 | 45 |
| 3 x 690 V | 4 | 7.5 | 11 | 18.5 | 22 | 22 | 30 |
| AC 3 3 x 230 V | 3 | 4 | 4 | 7.5 | 11 | 15 | 18.5 |
| 3 x 400 V | 4 | 5.5 | 7.5 | 15 | 18.5 | 22 | 30 |
| 3 x 500 V | 5.5 | 5.5 | 7.5 | 15 | 22 | 30 | 37 |
| 3 x 690 V | 3 | 5.5 | 7.5 | 15 | 18.5 | 18.5 | 22 |
| ► Make - break characteristics (A_{eff}/400 V) | | | | | | | |
| Rated make capacity | - | 710 | 710 | 1270 | 1270 | 1970 | 1970 |
| Rated break capacity | - | 330 | 330 | 800 | 800 | 800 | 800 |
| ► Short circuit characteristics | | | | | | | |
| Rated short term withstand current I_{cw} (A _{eff} /400 V/1 s) | 250 | 350 | 430 | 500 | 760 | 1100 | 1500 |
| Rated short circuit make capacity I_{cm} (kA peak/400 V) | - | 1 | 1 | 1.8 | 1.8 | 2.8 | 2.8 |
| Short circuit current (kA eff/400 V) | 6 | 10 | 10 | 10 | 10 | 10 | 10 |
| with fuse gI/gG (A) | 16 | 25 | 32 | 50 | 63 | 80 | 100 |
| ► Mechanical life AC 20 (million) | 1 | 0.1 | 0.1 | 0.04 | 0.04 | 0.04 | 0.04 |
| ► Connections | | | | | | | |
| Stranded wire + (min/max) cap (mm ²) | 0.75/2.5 | 0.75/6 | 0.75/6 | 1.5/16 | 1.5/16 | 2.5/35 | 2.5/35 |
| Solid wire (mm ²) | 4 | 10 | 10 | 25 | 25 | 50 | 50 |
| ► Storage temperature | -30°C TO +70 °C | | | | | | |
| ► Operating temperature | - 30°C TO +70 °C | | | | | | |
| ► Protection rating | rear of panel: IPxxB front of panel IP 40 in standard version (IP 65 on request) | | | | | | |
| ► Conformity to standards | IEC 60947-3, UL508, CSA22.2 | | | | | | |
| ► Approvals | UL - cUL (USA - Canada) suitable as motor disconnect. CB certification | | | | | | |
| ► Climatic resistance Tropical atmosphere according to | IEC 60068-2-30 Cyclic damp heat | | | | | | |

Technical characteristics

AUXILIARY CONTACTS

| Characteristics | 20 A | 25 A | 32 A | 50 A | 63 A | 80 A | 100 A |
|--|---------|---------|---------|---------|---------|---------|---------|
| ▶ Rated insulation voltage U_i (V) | 400 | 400 | 400 | 400 | 400 | 400 | 400 |
| ▶ Conventional free air thermal current I_{th} | | | | | | | |
| Continuous rated current I_u (A) | 20 | 10 | 10 | 10 | 10 | 10 | 10 |
| ▶ Rated operating current I_e (A) | | | | | | | |
| AC 15 | | | | | | | |
| 230 V | 6 | 6 | 6 | 6 | 6 | 6 | 6 |
| 400 V | - | 4 | 4 | 4 | 4 | 4 | 4 |
| ▶ PROTECTION AGAINST SHORT CIRCUIT BY FUSE G_G (A) | 16 | 10 | 10 | 10 | 10 | 10 | 10 |
| ▶ Max. connection stranded wire (mm ²) | 2 x 2.5 | 2 x 2.5 | 2 x 2.5 | 2 x 2.5 | 2 x 2.5 | 2 x 2.5 | 2 x 2.5 |

ENCLOSURES

| Characteristics | 150x100x96 | 220x150x100 | 220x150x100 | 220x150x100 | 220x150x100 | 300x200x100 |
|-------------------------------------|--|--|--------------------|---------------------|---------------------|--|
| ▶ Rating | 20, 25 and 32 A | 25 and 32 A | 50 and 63 A | 50 and 63 A | 80 and 100 A | 80 et 100 A |
| +NC/NO | 3P to 4P +NC/NO 20 A - 6P | 6P and 6P +NC/NO | 3P to 4P +NC/NO | 6P and 6P +NC/NO | 3P and 3P +NC/NO | 4P to 6P |
| ▶ Cable inputs | 2 x 2 PG 16 OR 2 x 2 M25 | 2 x 2 PG 21 | 2 x 2 PG 21 | 2 x 2 PG 29 | 2 x 2 PG 29 | 2 x 2 PG 21 and 2 x 2 PG 29 |
| ▶ \varnothing knockouts (mm) | PG 16: 22.5 ISO M25: 25 | 28.5 | 28.5 | 37.5 | 37.5 | 37.5 and 28.5 |
| ▶ No. of knockouts (top and bottom) | 2 | 2 | 2 | 2 | 2 | 4 |
| ▶ Panel mount | by 2 screws | by 4 screws | | | | |
| ▶ Base/cover assembly | by 1 screws self-tapping stainless steel | by 4 screws self-tapping stainless steel | | | | by 6 screws self-tapping stainless steel |
| ▶ Switch/base assembly | on 35 mm DIN rail (this rail is notched for positioning the switch) | | | | | |
| ▶ Handles mounting | screwing on shaft pre-pierced cover | | | | | |
| ▶ Insulation | Class II installed (provided that the correct insulation plugs are used with the enclosure) | | | | | |
| ▶ Impact withstand | IK07 | | | | | |
| ▶ Flameproof | 650°C | | | | | |
| ▶ Protection rating | IP 66 | IP 40 (IP 65 upon request) | | | | |
| ▶ Contact operating diagram | | | | | | |
| ▶ Switch padlocking | In general: up to 3 padlocks \varnothing 4 to 8 mm Switch with 1 auxiliary contact NC/NO: up to 3 padlocks \varnothing 6 to 8 mm Modular presentation: 1 padlock \varnothing 6 to 8 mm | | | | | |

Enclosure selection guide

► 25 AND 32 A



Example: switch disconnecter 32 A
Enclosed 4 poles,
padlockable presentation

Enclosure 150 x 100 x 96 mm

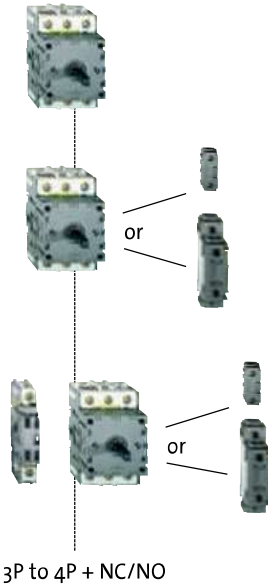

Enclosure 220 x 150 x 100 mm

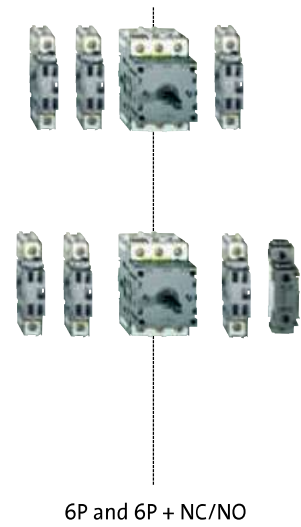

► 50 AND 63 A



Example: switch disconnecter 50 A
Enclosed 6 poles,
Plate, frame and handle presentation

Enclosure 220 x 150 x 100mm

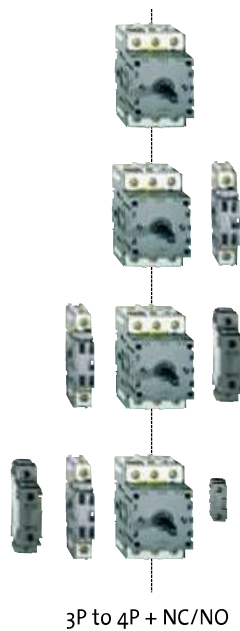

Enclosure 220 x 150 x 100 mm

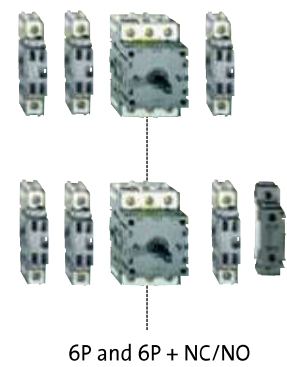

Enclosure selection guide

▶ 80 AND 100 A

Enclosure 220 x 150 x 100 mm

Enclosure 300 x 220 x 100 mm



Example: switch disconnecter 100 A
Enclosed 4 poles,
padlockable presentation

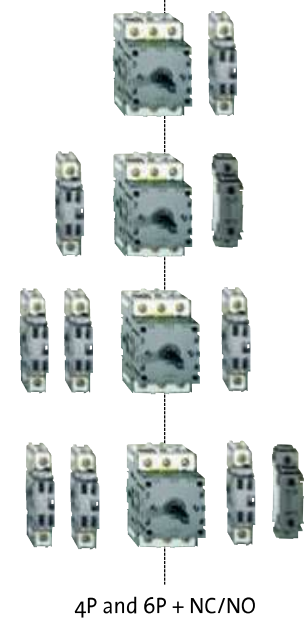
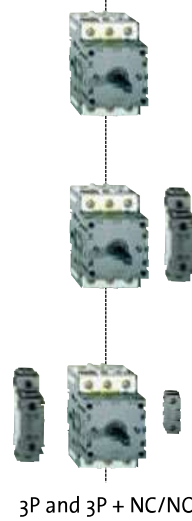

LEGEND



basic 3-pole block



additional pole
additional neutral pole
junction block



Auxiliary contact NC/NO



early break auxiliary contact

Possible configurations

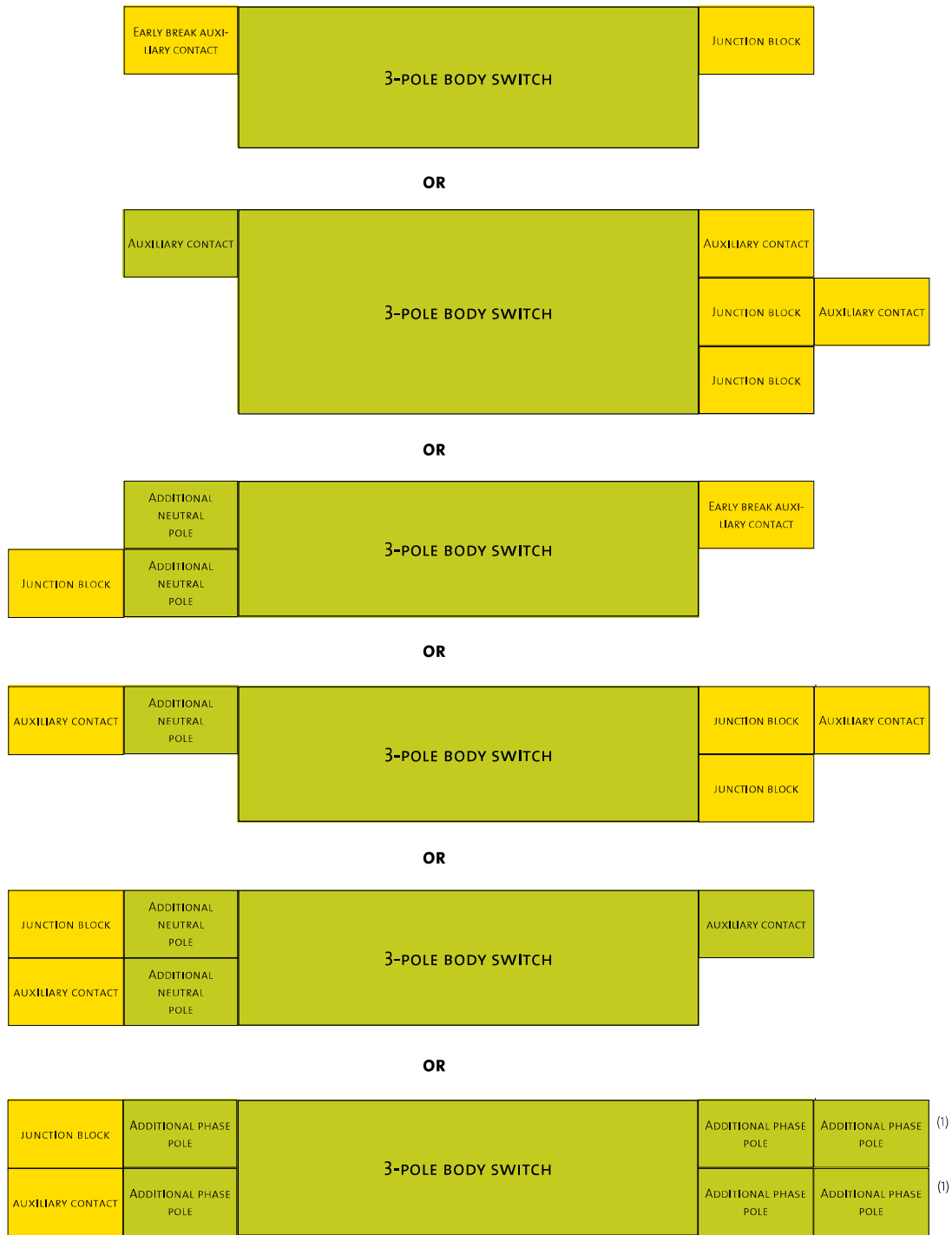

(1) version with enclosure only

- Complete switch disconnecter p. 284 to 295
- Permitted auxiliaries

Protection class

The IP (Ingress Protection) rating system is published by the IEC (International Electrotechnical Commission) and classifies the degree of protection against solid objects and liquids in order to operate the electrical equipment.



- 1** Protection Against Solid Objects
- 2** Protection Against Liquids

First digit of IP-Codes

| 1.digit | | Meaning | |
|-----------|-----------|-----------------------------|--|
| ISO 20653 | IEC 60529 | Protection against objects | Effective against |
| 0 | 0 | No protection | No protection |
| 1 | 1 | Solid objects \geq 50mm | Any large surface of the body, such as the back of a hand, but no protection against deliberate contact with a body part |
| 2 | 2 | Solid objects \geq 12.5mm | Fingers or similar objects |
| 3 | 3 | Solid objects \geq 2.5mm | Tools, thick wires, etc. |
| 4 | 4 | Solid objects \geq 1mm | Most wires, screws, etc. |
| 5K | 5 | Dust protected | Ingress of dust is not entirely prevented, but it must not enter in sufficient quantity to interfere with the satisfactory operation of the equipment; complete protection against contact |
| 6K | 6 | Dust tight | No ingress of dust; complete protection against contact |

Second digit of IP-Codes

| 2.digit | | Meaning |
|-----------|-----------|--|
| ISO 20653 | IEC 60529 | Protection against water |
| 0 | 0 | No protection |
| 1 | 1 | Dripping water (vertically falling drops) shall have no harmful effect. |
| 2 | 2 | Vertically dripping water shall have no harmful effect when the enclosure is tilted at an angle up to 15° from its normal position. |
| 3 | 3 | Water falling as a spray at any angle up to 60° from the vertical shall have no harmful effect. |
| 4 | 4 | Water splashing against the enclosure from any direction shall have no harmful effect. |
| 5 | 5 | Water projected by a nozzle (6.3 mm) against enclosure from any direction shall have no harmful effects. |
| 6 | 6 | Water projected in powerful jets (12.5 mm nozzle) against the enclosure from any direction shall have no harmful effects. |
| 7 | 7 | Ingress of water in harmful quantity shall not be possible when the enclosure is immersed in water under defined conditions of pressure and time (up to 1 m of submersion). |
| 8 | 8 | The equipment is suitable for continuous immersion in water under conditions which shall be specified by the manufacturer. Normally, this will mean that the equipment is hermetically sealed. However, with certain types of equipment, it can mean that water can enter but only in such a manner that it produces no harmful effects. |
| | 9 | Protected against close-range high pressure, high temperature spray downs. |
| 9K | | Protected against close-range high pressure, high temperature spray downs, specific for cars. |



BACO®

www.baco-international.com

BA217001

