

## DPA CL8 EA 4PPOE (929 161)

- Ideal for protecting Ethernet applications up to 10 GBit/s
- For use in structured cabling systems according to class E<sub>A</sub> up to 500 MHz
- Power over Ethernet IEEE 802.3 compliant (up to PoE++ / 4PPoE)
- For installation in conformity with the lightning protection zone concept at the boundaries from 0<sub>A</sub> –2 and higher

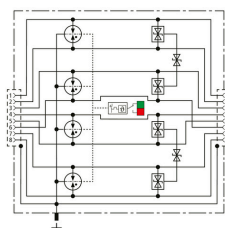

Figure without obligation



Basic circuit diagram DPA CL8 EA 4PPOE

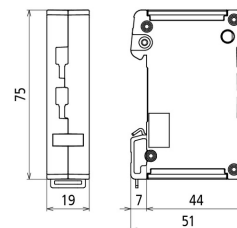

Dimension drawing DPA CL8 EA 4PPOE

Universal, space-saving combined arrester of 19 mm in width and RJ45 connection system with status indication for simple maintenance. Protection of applications in structured cabling according to class E<sub>A</sub> to 500 MHz; e.g. industrial Ethernet, data distributors, digital camera systems, Power over Ethernet (IEEE 802.3 compliant to 4PPoE) and Ethernet-based interfaces in general. Protection of all pairs through powerful gas discharge tubes and protective diodes between signal cores and pairs. Fully shielded adapter design with RJ45 sockets for DIN rail mounting. With additional screw connection on the enclosure for an optional earth connection.

| Type   | DPA CL8 EA 4PPOE                 |
|--|----------------------------------|
| Part No.   | 929 161                          |
| SPD class  | TYPE 1 P2                        |
| Impulse category   | D1, C1, C2, C3                   |
| Nominal voltage (U <sub>N</sub> )  | 3.3 V                            |
| Max. continuous operating voltage (d.c.) (U <sub>c</sub> )                       | 3.3 V                            |
| Max. continuous operating voltage (d.c.) pair-pair (PoE) (U <sub>c</sub> )       | 58 V                             |
| Nominal current (I <sub>N</sub> )  | 1.5 A                            |
| D1 Lightning impulse current (10/350 μs) per line (I <sub>imp</sub> )            | 0.5 kA                           |
| C2 Nominal discharge current (8/20 μs) line-line (I <sub>n</sub> )               | 150 A                            |
| C2 Nominal discharge current (8/20 μs) line-PG (I <sub>n</sub> )                 | 2.5 kA                           |
| C2 Total nominal discharge current (8/20 μs) (I <sub>n</sub> )                   | 10 kA                            |
| C2 Nominal discharge current (8/20 μs) pair-pair (PoE) (I <sub>n</sub> )         | 150 A                            |
| Voltage protection level line-line for I <sub>n</sub> C2 (U <sub>p</sub> )       | ≤ 100 V                          |
| Voltage protection level line-PG for I <sub>n</sub> C2 (U <sub>p</sub> )         | ≤ 600 V                          |
| Voltage protection level line-line for I <sub>n</sub> C2 (PoE) (U <sub>p</sub> ) | ≤ 100 V                          |
| Voltage protection level line-line at 1 kV/μs C3 (U <sub>p</sub> )               | ≤ 140 V                          |
| Voltage protection level line-PG at 1 kV/μs C3 (U <sub>p</sub> )                 | ≤ 500 V                          |
| Voltage protection level pair-pair at 1 kV/μs C3 (PoE) (U <sub>p</sub> )         | ≤ 170 V                          |
| Cut-off frequency (f <sub>c</sub> )  | 500 MHz                          |
| Capacitance line-line (C)  | ≤ 15 pF                          |
| Capacitance line-PG (C)  | ≤ 40 pF                          |
| Operating temperature range (T <sub>U</sub> )                                    | -40°C to +80°C                   |
| Degree of protection   | IP 20                            |
| For mounting on  | 35 mm DIN rails acc. to EN 60715 |
| Connection (input / output)  | RJ45 socket / RJ45 socket        |
| Pinning  | 1/2, 3/6, 4/5, 7/8               |
| Earthing via   | 35 mm DIN rail acc. to EN 60715  |
| Enclosure material   | zinc die casting                 |
| Colour   | bare surface                     |
| Test standards   | IEC 61643-21 / EN 61643-21       |
| Approvals  | GHMT, UL 497B                    |
| Weight   | 180 g                            |
| Customs tariff number (Comb. Nomenclature EU)                                    | 85363010                         |
| GTIN   | 4013364472921                    |
| PU   | 1 pc(s)                          |

We reserve the right to introduce changes in performance, configuration and technology, dimensions, weights and materials in the course of technical progress. The figures are shown without obligation.