



SIGNAL TOWER Ø 50MM CT5

CT5

915510005
CT5ZM Piezo buzzer module 24V DC

- Cost effective modular 50 mm Ø signal tower
- Suited for 24V DC applications
- Up to 5 stackable modules
- LED multifunction and LED steady light modules in 6 colours



PRODUCT DESCRIPTION

One of the most cost-effective signal towers on the market, the new robust CT5 50mm signal tower has been developed for classic 24V DC applications and allows up to 5 different modules to be stacked.

- Cost-optimised modular 50 mm Ø signal tower
- 24V DC applications
- Up to 5 positions possible
- Polycarbonate housing
- IP65 rated
- LED multifunction and LED continuous light modules in 6 colours
- Efficient sound module selectable up to 95 dB – 8 tones
- Optimised 'resilient' bayonet system enables high stability, even without sealing rings
- Five-pole M12 base with automatic contacting push-in system
- Various mounting types

TECHNICAL DATA

DATA

Housing Colour	Black
IP class	IP65
Sound level max	95 dB
Nominal voltage	24 V DC
Nominal current max	0.035 A
Temperature operational min	-30 °C
Temperature operational max	60 °C
Weight	27 g

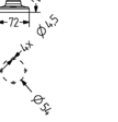
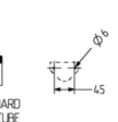
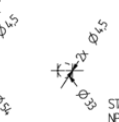
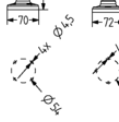
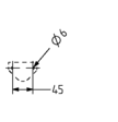
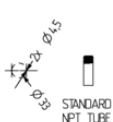
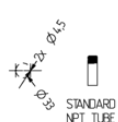
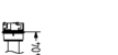
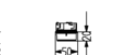
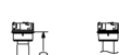

STANDARD
NPT TUBE

STANDARD
NPT TUBE