



CUBIC WARNING LIGHT LED SERIES Q

876161405

LED Steady/flashing+Buzzer, 94mm, Amber, 24 V
ac/dc, QSS

- IP 66
- LED / Xenon
- Can be combined with siren series "A"



PRODUCT DESCRIPTION

The Q Series warning lights combine modern LED and Xenon strobe technologies to deliver powerful and reliable signal strength in a compact design. Featuring a unique lens, these lights produce a clear, bright light with excellent spread. The LED option ensures long life, low power consumption, and superior durability, especially against vibrations. With an IP66 rating, the Q Series is robust enough for use in industrial, fire, marine, and other demanding environments. Additionally, these warning lights can be seamlessly integrated with the siren series "A" for enhanced signalling capabilities.

TECHNICAL DATA

| | |
|-----------------------------|-------------|
| Diameter | 94mm |
| Housing Colour | Red |
| IK class | 9 |
| IP class | IP65 |
| Lens colour | Orange |
| Light source | LED |
| Light type | Orange LED |
| Mounting | Independent |
| Sound level max | 80 dB |
| Supply voltage ac/dc max | 24 V |
| Supply voltage ac/dc min | 24 V |
| Temperature operational max | 60 °C |
| Temperature operational min | -30 °C |

Terminal connection

2.5 mm²

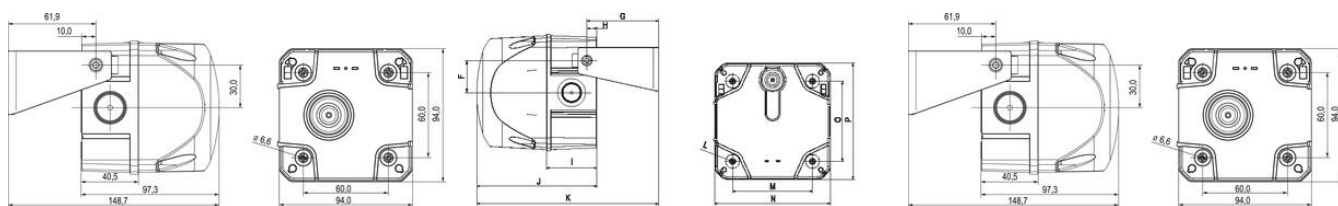

| | A | B | C | D | E | F | G | H | I | J | K | L | M | N | O | P |
|--------|-------|-----|----|----|-----|------|-------|------|------|-------|-------|-----|-------|-------|-------|-------|
| Size 2 | 143 | 96 | 10 | 32 | 50 | 36.6 | 81.6 | 11.5 | 57.4 | 136.8 | 206.8 | 6.5 | 91 | 131.8 | 91 | 131.8 |
| Size 3 | 199 | 112 | 16 | 48 | 70 | 56 | 105.5 | 18.5 | 72.5 | 175.8 | 262.8 | 6.5 | 124 | 183.5 | 124 | 183.5 |
| Size 4 | 243.3 | 140 | 10 | 70 | 100 | 83 | 133.3 | 16.8 | 90.8 | 223.8 | 340 | 167 | 228.4 | 167 | 228.4 | 16.5 |

Measuring unit mm

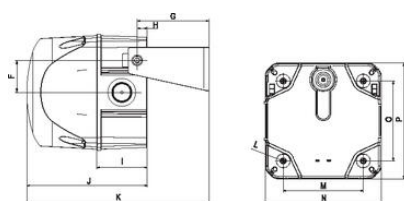

| | A | B | C | D | E | F | G | H | I | J | K | L | M | N | O | P |
|--------|-------|-----|----|----|-----|------|-------|------|------|-------|-------|-----|-------|-------|-------|-------|
| Size 2 | 143 | 96 | 10 | 32 | 50 | 36.6 | 81.6 | 11.5 | 57.4 | 136.8 | 206.8 | 6.5 | 91 | 131.8 | 91 | 131.8 |
| Size 3 | 199 | 112 | 16 | 48 | 70 | 66 | 105.5 | 18.5 | 72.5 | 175.2 | 262.8 | 6.5 | 124 | 183.5 | 124 | 183.5 |
| Size 4 | 243.3 | 140 | 10 | 70 | 100 | 83 | 133.3 | 16.8 | 90.5 | 223.4 | 340 | 167 | 228.4 | 167 | 228.4 | 6.5 |

Measuring unit mm