

## KUEBLER - MAGNET SENSOR LI50 WITH MAGNETIC TAPE B2

SERIE 8.LI50

- Resolution up to 0.005 mm
- Contactless measuring technology
- Status LED
- IP67 Impervious to chips, oil, water, etc.



### PRODUCT DESCRIPTION

Linear sensor used to measure linear movements with high accuracy, for example in woodworking machines, lathes, material handling, overhead cranes etc. The sensor is almost entirely non-sensitive to chips, oil, dust and water and can thus be used in troublesome environments, it is sealed and has no moving parts. This sensor is fitted to read a magnetic tape with a self-adhesive underside. This sensor is available with different resolutions, and if the recipient (counter/PLC) has a multiplication function, a resolution of 5 µm can be achieved. See electrical data (Resolution, Accuracy) for more information. Magnetic tape B2 has a polar distance of 5 mm. For the combination LI50/B2, the distance between sensor and tape must be 0.1 to 2.0 mm (1.0 mm is recommended). For the magnet sensor, the slope must not exceed ±3°, the rotation must not exceed ±3° and the offset must not exceed ±1 mm.

The following information is required to select the right combination:

- requirement on accuracy (from 0.1 mm to 0.005 mm)
- the movement's speed (taking into account frequency to subsequent systems and the sensor's max. speed)
- the movement's length (to order the magnetic scale's length = required length of measurement + 1 dm)

Please refer to the images below for ordering information.

Order code sensor head Limes LI50		8.LI50 . X1X1 . 2XXX						
		Type	a	b	c	d	e	f
<b>a</b> Model	1 = IP67, standard 2 = IP68 / IP69k and humidity tested acc. to EN 60068-3-38, EN 60068-3-78	<b>c</b> Output circuit / power supply	1 = RS422 / 4.8 ... 26 V DC 2 = Push-pull / 4.8 ... 30 V DC		<b>e</b> Reference signal	2 = index periodic		<b>Stock types</b>
<b>b</b> Pulse edge interval	1 = standard	<b>d</b> Type of connection	1 = cable, 2 m [6.56'] PUR		<b>f</b> Code (resolution) <sup>1)</sup>	050 = 25 µm 250 = 5 µm		8.LI50.1111.2050 8.LI50.1111.2250 8.LI50.1121.2050 8.LI50.1121.2250
Order code magnetic band Limes B2		8.B2 . 10 . 010 . XXXX						
		Type	a	b				
<b>a</b> Width	10 = 10 mm	<b>b</b> Length	0010 = 1 m	0060 = 6 m	<b>Optional on request</b>		<b>Stock types</b>	
			0020 = 2 m	0100 = 10 m	- other lengths up to 70 m		8.B2.10.010.0020	
			0040 = 4 m	0200 = 20 m				
			0050 = 5 m					

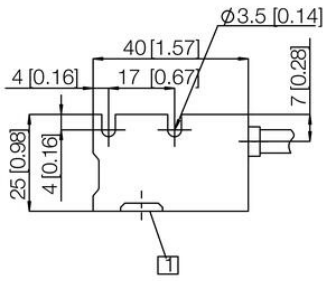

1 mätområde

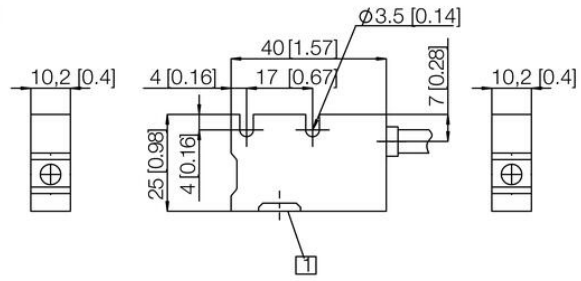

1 mätområde