

SUNGIL - FLEXIBLE SHAFT COUPLING, SDWA

SDWA-31C-8X8
SDWA-31C-8X8

- Maintenance free
- High torsional rigidity
- Low inertia
- For 3mm to 50mm diameter shafts
- Supplied machined to shaft requirements



PRODUCT DESCRIPTION

SDWA is a robust, three-part precision coupling which is able to withstand speeds of up to 3000 rpm and a max. torque of 44 Nm.

Its unique design means that it provides galvanic separation and is easy to install.

Able to withstand angle deviations of up to 0.5°.

TECHNICAL DATA

Angle deviation	3 °
Axial displacement	0.4 mm
Dimension D1	8 mm
Dimension D2	8 mm
Parallel displacement	0.2 mm
Torque max	6

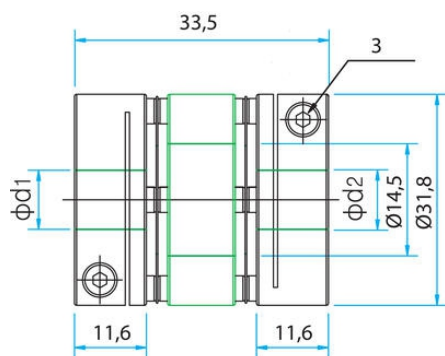

(mm)

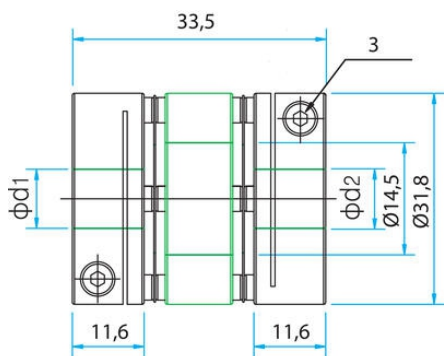
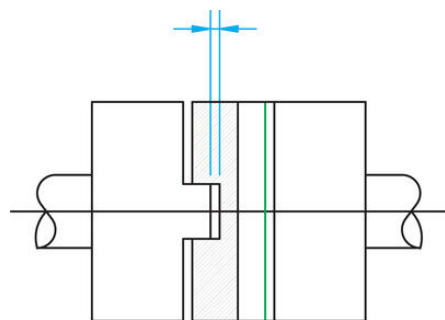
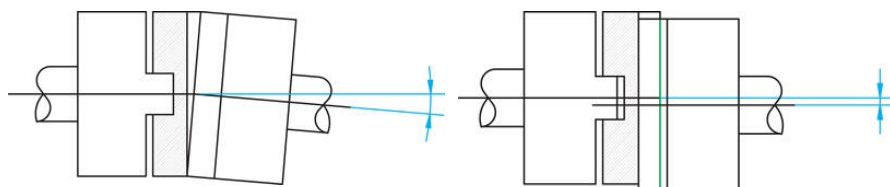

(mm)

