

KUBLER SLIP RING SR060E

SR060E-25-2-3-132
SLIP RING 2 SIGNAL / 3 POWER 25MM SHAFT

- Standard slipring
- Life span 50 million revolutions
- Easily accessible contacts
- IP64



PRODUCT DESCRIPTION

SR060E is a compact slip ring for up to 3 power and 2 data transmissions from a stationary to a rotating platform. The power and data transmission takes place securely via trailer contacts.

New innovative contact materials have a long service life and extremely little maintenance during operation. The round shape with smooth surfaces and a high level of protection allow easy cleaning.

Examples of applications: packaging machines, textile machines, robots and handling equipment, rotating tables, etc.

TECHNICAL DATA

Contact resistance channel	1 Ω
Contact resistance data channel	0.1 Ω
Dielectric strength	1000 kV/m
Hollow shaft diameter max	25 mm
Insulation resistance	10 ³ Ohm(500VDC)
IP class	IP64
Life span	500000000 revolution
Power load max	16 A
Signal load	2 A
Speed max	500 m/s
Temperature operational max	75 °C
Temperature operational min	0 °C
Voltage input	240 V

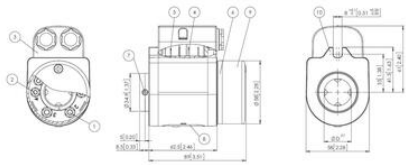

- 1 - Screw terminal M3 for load transmission
- 2 - Screw terminal M3 for signal transmission
- 3 - Protective cover for the stator connections with screwed assembly (only IP44)
- 4 - Flat pin connection for load transmission
- 5 - Flat pin connection for signal transmission
- 6 - Rotating connection ring
- 7 - 4 x socket set screw DIN 914 M3
- 8 - Maintenance window
- 9 - Protective cover for connections
- 10 - Torque stop

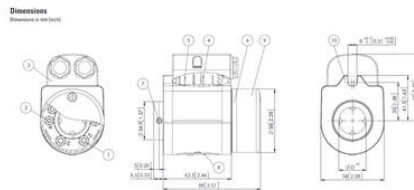

- Dimensions**
Dimensions in mm (inch)
- 1 - Screw terminal M3 for power transmission
 - 2 - Screw terminal M3 for signal transmission
 - 3 - Protective cover for the stator connections with screwed assembly (only IP44)
 - 4 - Flat pin connection for power transmission
 - 5 - Flat pin connection for signal transmission
 - 6 - Rotating connection ring
 - 7 - 4 x socket set screw DIN 914 M3
 - 8 - Maintenance window
 - 9 - Protective cover for connections
 - 10 - Torque stop

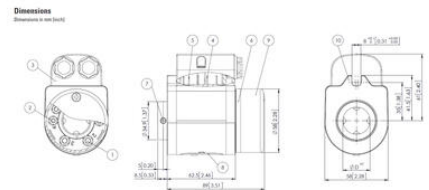

- Dimensions**
Dimensions in mm (inch)
- 1 - Screw terminal M3 for power transmission
 - 2 - Screw terminal M3 for signal transmission
 - 3 - Protective cover for the stator connections with screwed assembly (only IP44)
 - 4 - Flat pin connection for power transmission
 - 5 - Flat pin connection for signal transmission
 - 6 - Rotating connection ring
 - 7 - 4 x socket set screw DIN 914 M3
 - 8 - Maintenance window
 - 9 - Protective cover for connections
 - 10 - Torque stop