



## DOGA - 162 SERIES

DC motor only, planetary option

162.4101.20.00

Motor 12 V dc, 0.18 Nm, 2800 rpm, 7.5 A, shaft E2

- 12-24Vdc
- Up to 0.2Nm
- Up to 3000rpm
- 60mm diameter
- High starting torque



### PRODUCT DESCRIPTION

The DOGA 162 series is a range of 60mm diameter permanent magnet DC motors that are developed for a compact, low noise and cost-effective solution to suit many industrial applications. IP53 is standard, with an EMC filter option.

VOLTAGE: 12 / 24Vdc supply - ideally suited to **battery powered** and **mobile applications**.

TORQUE: >0.2Nm nominal, >1.0Nm starting – a good choice for applications requiring **high start-up power**.

SPEED: 1500 - 3000rpm options.

For modest quantities DOGA can offer **product customisation** to better suit the individual needs of the customer and application. Adaptations can include changes to the output shaft, supply voltage, cabling/connectors and motor windings.

Typical applications include:

Agriculture  
Building access  
Care aid  
Medical  
Office equipment  
Marine  
General industrial automation

### TECHNICAL DATA

Current max	33 A
EMC filter	No
IP class	IP53
Max. torque	1

Nominal current	7.5 A
Nominal speed	2800 rpm
Nominal torque	0.18
Shaft diameter	8 mm
Supply voltage	12 V DC
Weight	1.1 kg

**A**

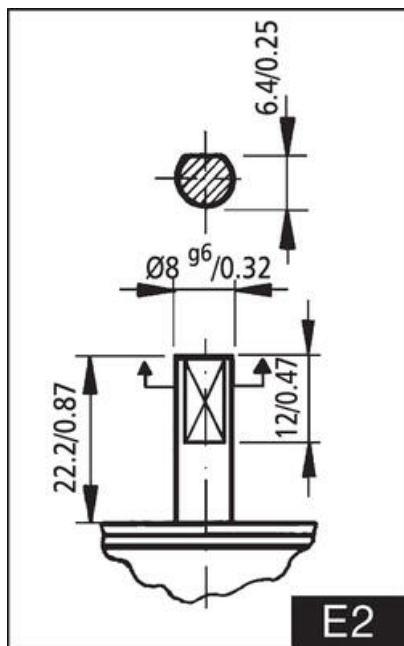
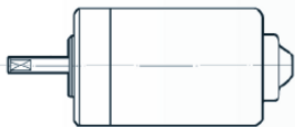

**E2**

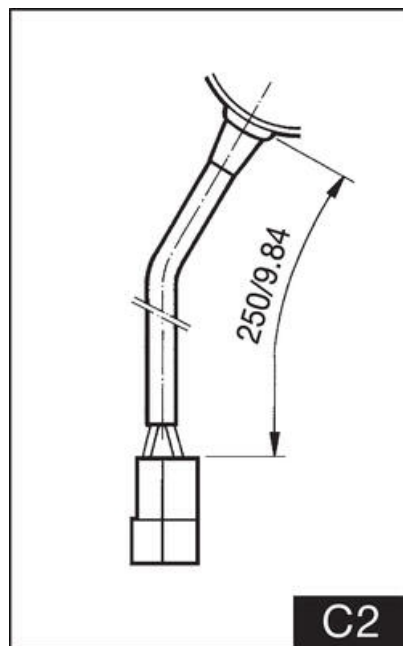

**C2**

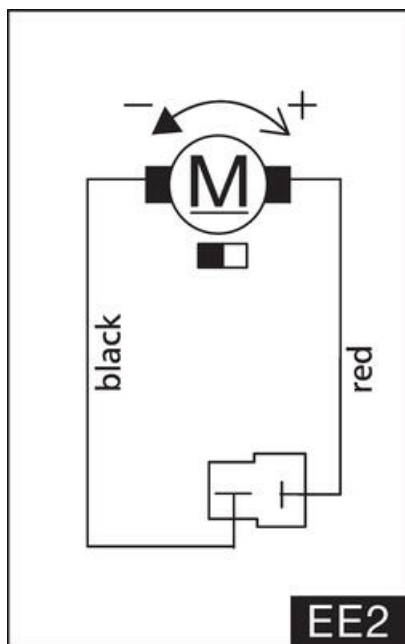

**EE2**

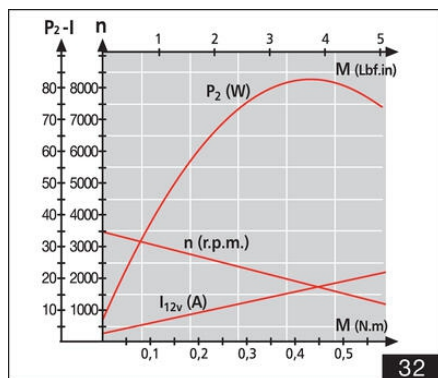

**32**

