

**KUEBLER - ABSOLUTE-CODED  
 ANGULAR TRANSMITTER SENDIX  
 5868/5888, OPTICAL, PROFINET, Ø58 MM  
 SERIE 5868 PROFINET**



- Housing diameter Ø58 mm
- Profinet
- Safety-Lock™
- High enclosure class

**PRODUCT DESCRIPTION**

Sendix 5868/5888 is a multivariate sensor with Profinet in robust design. Thanks to the construction of Safety-Lock™ as well as the fully cast housing, the sensor is able to handle even the more demanding applications where there are high demands on the sensor. The wide temperature range combined with the high enclosure class allows the sensor to be used outdoors as well as applications where large temperature changes occur.

Please refer to the images below for ordering information.

<b>Order code</b> Shaft version	<b>8.5868</b> Type	<b>.XXC2</b> a b c d	<b>.C2 12</b> e
<b>a Flange</b>	<b>b Shaft (ø x L), with flat</b>	<b>c Interface / power supply</b>	<b>e Fieldbus profile</b>
1 = clamping flange, IP65 ø 58 mm [2.28"] 3 = clamping flange, IP67 ø 58 mm [2.28"] 2 = synchro flange, IP65 ø 58 mm [2.28"] 4 = synchro flange, IP67 ø 58 mm [2.28"] 5 = square flange, IP65 □ 63.5 mm [2.5"] 7 = square flange, IP67 □ 63.5 mm [2.5"]	1 = 6 x 10 mm [0.24 x 0.39"] <sup>1)</sup> 2 = 10 x 20 mm [0.39 x 0.79"] <sup>2)</sup> 3 = 1/4" x 7/8" 4 = 3/8" x 7/8"	C = PROFINET IO / 10 ... 30 V DC	C2 = PROFINET IO
		d Type of connection removable bus terminal cover 2 = 3 x M12 connector, 4-pin	Optional on request - Ex 2/22 - surface protection salt spray tested

<b>Order code</b> Hollow shaft	<b>8.5888</b> Type	<b>.XXC2</b> a b c d	<b>.C2 12</b> e
<b>a Flange</b>	<b>b Blind hollow shaft</b>	<b>c Interface / power supply</b>	<b>e Fieldbus profile</b>
1 = with spring element, long, IP65 2 = with spring element, long, IP67 3 = with stator coupling, IP65 ø 65 mm [2.56"] 4 = with stator coupling, IP67 ø 65 mm [2.56"] 5 = with stator coupling, IP65 ø 63 mm [2.48"] 6 = with stator coupling, IP67 ø 63 mm [2.48"]	(insertion depth max. 30 mm [1.18"]) 3 = ø 10 mm [0.39"] 4 = ø 12 mm [0.47"] 5 = ø 14 mm [0.55"] 6 = ø 15 mm [0.59"] 8 = ø 3/8" 9 = ø 1/2"	C = PROFINET IO / 10 ... 30 V DC	C2 = PROFINET IO
		d Type of connection removable bus terminal cover 2 = 3 x M12 connector, 4-pin	Optional on request - Ex 2/22 - surface protection salt spray tested

**TECHNICAL DATA**

<b>Connection</b>	M12
<b>Housing diameter</b>	58 mm
<b>IP class</b>	IP65, IP67
<b>Mounting</b>	Shoulder

<b>Output</b>	ProfiNet
<b>Resolution MT</b>	Max. 12 bit
<b>Resolution overall</b>	28 bit (default 25 bit)
<b>Resolution ST</b>	16 bit (default 13 bit)
<b>Sensor type</b>	Absolute
<b>Shaft diameter max</b>	10 mm
<b>Shaft diameter min</b>	6 mm
<b>Supply voltage dc max</b>	30 V DC
<b>Supply voltage dc min</b>	10 V DC
<b>Temperature operational max</b>	85 °C
<b>Temperature operational min</b>	-40 °C
<b>Version</b>	Multiturn

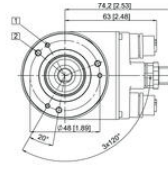
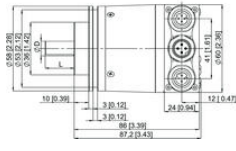
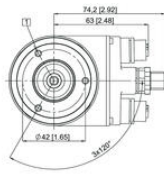
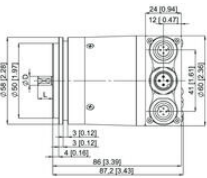

Interface	Type of connection	Function	M12 connector					
C	(3 x M12 connector)	Bus port 1	Signal:	Transmit data-	Receiver data-	Transmit data	Receiver data	1 - 2
		Abbreviation:	TxD-	RxD-	TxD	RxD	4 - 3	
		Pin:	1	2	3	4	4 - 3	
		Power supply	Signal:	Voltage +	-	Voltage -	-	1 - 2
		Abbreviation:	+V	-	0V	-	4 - 3	
		Pin:	1	2	3	4	1 - 2	
		Bus port 2	Signal:	Transmit data-	Receiver data-	Transmit data	Receiver data	1 - 2
		Abbreviation:	TxD-	RxD-	TxD	RxD	4 - 3	

Interface	Type of connection	Function	M12 connector					
C	(3 x M12 connector)	Bus port 1	Signal:	Transmit data-	Receiver data-	Transmit data	Receiver data	1 - 2
		Abbreviation:	TxD-	RxD-	TxD	RxD	4 - 3	
		Pin:	1	2	3	4	4 - 3	
		Power supply	Signal:	Voltage +	-	Voltage -	-	1 - 2
		Abbreviation:	+V	-	0V	-	4 - 3	
		Pin:	1	2	3	4	1 - 2	
		Bus port 2	Signal:	Transmit data-	Receiver data-	Transmit data	Receiver data	1 - 2
		Abbreviation:	TxD-	RxD-	TxD	RxD	4 - 3	