

**KUEBLER - ABSOLUTE-CODED
 ANGULAR TRANSMITTER SENDIX
 5868/5888, OPTICAL, PROFIBUS, Ø58 MM
 SERIE 5868 PROFIBUS**

- Housing diameter Ø58 mm
- Profibus
- High shock resistance
- High enclosure class





PRODUCT DESCRIPTION

Sendix 5868/5888 is a multivariate fieldbus sensor with Profibus in robust design. Thanks to the construction of Safety-Lock™ as well as the fully cast housing, the sensor is able to handle even the more demanding applications where there are high demands on the sensor. The wide temperature range combined with the high enclosure class allows the sensor to be used outdoors as well as applications where large temperature changes occur. Sendix 5868/5888 has LED indication which facilitates diagnosis of the sensor and a set button that facilitates calibration.

Please refer to the images below for ordering information.

| | | | |
|----------------------|---------------|--------------|--------------|
| Order code | 8.5868 | .XX3X | .311X |
| Shaft version | Type | a b c d | e f |

| | | |
|--|--|--|
| <p>a Flange</p> <p>1 = clamping flange, IP65 ø 58 mm [2.28"] 3 = clamping flange, IP67 ø 58 mm [2.28"]</p> <p>2 = synchro flange, IP65 ø 58 mm [2.28"] 4 = synchro flange, IP67 ø 58 mm [2.28"]</p> <p>5 = square flange, IP65 □ 63.5 mm [2.5"] 7 = square flange, IP67 □ 63.5 mm [2.5"]</p> <p>b Shaft (ø x L), with flat</p> <p>1 = 6 x 10 mm [0.24 x 0.39"]¹⁾ 2 = 10 x 20 mm [0.39 x 0.79"]²⁾</p> <p>3 = 1/4" x 7/8" 4 = 3/8" x 7/8"</p> | <p>c Interface / power supply</p> <p>3 = PROFIBUS DP V0 encoder profile V 1.1, 10 ... 30 V DC</p> <p>d Type of connection, removable bus terminal cover</p> <p>1 = with radial cable gland fitting 2 = with 3 x radial M12 connectors</p> <p><i>Optional on request</i></p> <ul style="list-style-type: none"> - Ex 2/22 - surface protection salt spray tested - seawater resistant (stainless steel V4A) <p><i>Salt spray tested / stainless steel V4A as standard types (deliverable as from 1 unit)</i></p> <div style="display: flex; justify-content: space-around;"> <div style="text-align: center;">  <p>salt spray tested: 8.5868.3232.3112-C</p> </div> <div style="text-align: center;">  <p>stainless steel V4A: 8.5868.3232.3112-V4A</p> </div> </div> | <p>e Fieldbus profile</p> <p>31 = PROFIBUS DP V0 encoder profile class 2</p> <p>f Options (service)</p> <p>2 = no option 3 = SET button</p> |
|--|--|--|

Order code
Hollow shaft

8.5888 . **XX3X** . **311X**
Type **a** **b** **c** **d** **e** **f**

a Flange

- 1 = with spring element, long, IP65
- 2 = with spring element, long, IP67
- 3 = with stator coupling, IP65 ø 65 mm [2.56"]
- 4 = with stator coupling, IP67 ø 65 mm [2.56"]
- 5 = with stator coupling, IP65 ø 63 mm [2.48"]
- 6 = with stator coupling, IP67 ø 63 mm [2.48"]

b Blind hollow shaft

(insertion depth max. 30 mm [1.18"])

- 3 = ø 10 mm [0.39"]
- 4 = ø 12 mm [0.47"]
- 5 = ø 14 mm [0.55"]
- 6 = ø 15 mm [0.59"]
- 8 = ø 3/8"
- 9 = ø 1/2"

c Interface / power supply

3 = PROFIBUS DP V0 encoder profile V 1.1, 10 ... 30 V DC

d Type of connection, removable bus terminal cover

- 1 = with radial cable gland fitting
- 2 = with 3 x radial M12 connectors

e Fieldbus profile

31 = PROFIBUS DP V0
encoder profile class 2

f Options (service)

- 2 = no option
- 3 = SET button

Optional on request

- Ex 2/22
- surface protection salt spray tested
- seawater resistant (stainless steel V4A)

Salt spray tested / stainless steel V4A as standard types (deliverable as from 1 unit)



salt spray tested:
8.5888.2432.3112-C
8.5888.2532.3112-C



stainless steel V4A:
8.5888.2432.3112-V4A

TECHNICAL DATA

| | |
|-----------------------------|------------------------------|
| Connection | Cable, M12 |
| Housing diameter | 58 mm |
| IP class | IP65, IP67 |
| Mounting | Shoulder |
| Output | Profibus |
| Resolution MT | 12 bit |
| Resolution overall | Max. 28 bit (default 25 bit) |
| Resolution ST | 16 bit (default: 13 bit) |
| Sensor type | Absolute |
| Shaft diameter max | 10 mm |
| Shaft diameter min | 6 mm |
| Supply voltage dc max | 30 V DC |
| Supply voltage dc min | 10 V DC |
| Temperature operational max | 80 °C |
| Temperature operational min | -40 °C |
| Version | Multiturn |

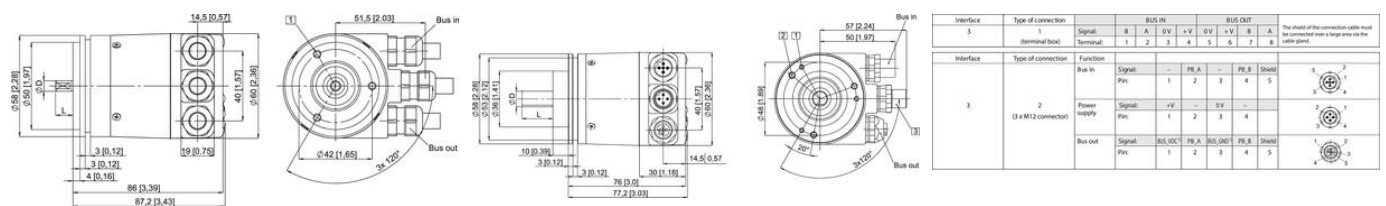

| Interface | Type of connection | BUS IN | | | | | BUS OUT | | | The shield of the connection cable must be connected near a large area on the cable gland. | | |
|-----------|--------------------------|--------------|--------|---------|------|---------|---------|--------|---|--|---|---|
| | | Signal | B | A | DV | +V | DV | +V | B | | A | |
| | | Terminal | 1 | 2 | 3 | 4 | 5 | 6 | 7 | 8 | | |
| 3 | 1 (terminal box) | | | | | | | | | | | |
| Interface | Type of connection | Function | | | | | | | | | | |
| | | Signal | - | PS A | - | PS B | Shield | 1 | 2 | 3 | 4 | |
| 3 | 2 (3 x M12 connector) | Bus in | Signal | - | PS A | - | PS B | Shield | 1 | 2 | 3 | 4 |
| | | Power supply | Signal | +V | - | DV | - | | 1 | 2 | 3 | 4 |
| | | Bus out | Signal | BUS OUT | PS A | BUS OUT | PS B | Shield | 1 | 2 | 3 | 4 |