

## AUTOVIMATION MAMMOTH ENCLOSURES

22.966.180

Mammoth M, 3", rear wall C (29x<150mm)

- Robust enclosure, max. camera size up to 90x150mm
- Maximum lens diameter 90mm in profile, 78mm in front lid
- Inner length 199mm (M), 259mm (L) and 309mm (XL)
- Excellent heat dissipation, IP65 rated
- Wide selection of accessories available for mounting and maintenance



### PRODUCT DESCRIPTION

#### Enclosure Configurator

The Mammoth enclosure protects large MV-cameras of up to 90 x 150mm cross section, for instance larger line scan or thermal cameras (Dalsa Spyder, e2V\_ELiiXA, Flir A600 series and more). It is available with 180, 250 and 300mm internal length. As with other dovetail enclosures, the camera mounts in any position so the front lens can always be placed right behind the front window. Dovetail adapters on two enclosure sides make the Mammoth compatible to autoVimation's Machine-Vision Construction Kit.

autoVimation offers a wide selection of enclosures to suit even the most specific requirements. To find a suitable enclosure please see the Enclosure Configurator (link above) or contact OEM Finland sales team for additional info!

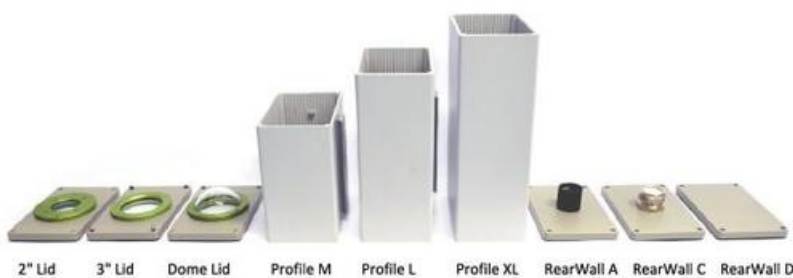

Order Numbers (please specify the camera type for each order!):

Enclosure Size	Rear Wall	Order Number	Enclosure Size	Rear Wall	Order Number
M, 3" Window	A	2X.X65.180	L, 3" Germanium Window, for e.g. Flir A600	C	2X.X68.250
	C	2X.X66.180		A	2X.X65.300
	D	2X.X67.180		C	2X.X66.300
L, 3" Window	A	2X.X65.250	XL, 3" Window	D	2X.X67.300
	C	2X.X66.250			
	D	2X.X67.250			

### TECHNICAL DATA

Height 113 mm

Housing material Powder coated marine aluminum

Inner length	189 mm
IP class	IP65
Length	207 mm
Max camera height	90 mm
Max camera width	150 mm
Max connector size	26.5 mm
Max lens diameter	90 mm
Weight	2300 g
Width	173 mm
Window seal	EPDM



Order Numbers (please specify the camera type for each order!)

Enclosure Size	Rear Wall	Order Number	Enclosure Size	Rear Wall	Order Number
M, 3" Window	A	ZK.X65.180	L, 3" Germanium Window, for e.g. Flir A600	C	ZK.X68.250
	C	ZK.X66.180		C	ZK.X68.250
	D	ZK.X67.180		C	ZK.X66.300
L, 3" Window	A	ZK.X65.250	XL, 3" Window	A	ZK.X65.300
	C	ZK.X66.250		C	ZK.X66.300
	D	ZK.X67.250		D	ZK.X67.300

Accessories:

Product	Image	Order No.	Product	Image	Order No.	Product	Image	Order No.
2" Wind Curtain		50.100.010	Cooling Module		60.100.020	Mounting Kit 7		5.070.000
Tube Wind Curtain 2"		50.100.017	Corrugated Tube 28mm		20.000.006	Mounting Kit 9		5.090.000
3" Wind Curtain		50.100.011	Mounting Kit 1		5.010.000	Mounting Kit 10		5.100.000
Dome Window		20.040.015	Mounting Kit 2		5.020.000	Mounting Kit 15		5.150.000
30mm Extension		15.030.030	Mounting Kit 6		5.060.000	Mounting Kit 16		5.160.000
60mm Extension		15.030.085	M12 Front Lid		20.040.018	Mounting Kit 17		5.170.000
						Mounting Tool		90.000.004

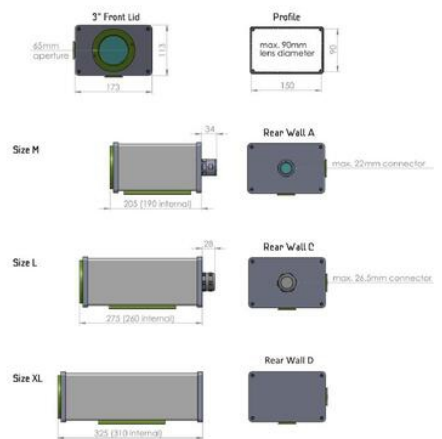

Order Numbers (please specify the camera type for each order!)

Enclosure Size	Rear Wall	Order Number	Enclosure Size	Rear Wall	Order Number
M, 3" Window	A	ZK.X65.180	L, 3" Germanium Window, for e.g. Flir A600	C	ZK.X68.250
	C	ZK.X66.180		C	ZK.X68.250
	D	ZK.X67.180		C	ZK.X66.300
L, 3" Window	A	ZK.X65.250	XL, 3" Window	A	ZK.X65.300
	C	ZK.X66.250		C	ZK.X66.300
	D	ZK.X67.250		D	ZK.X67.300

Accessories:

Product	Image	Order No.	Product	Image	Order No.	Product	Image	Order No.
2" Wind Curtain		50.100.010	Cooling Module		60.100.020	Mounting Kit 7		5.070.000
Tube Wind Curtain 2"		50.100.017	Corrugated Tube 28mm		20.000.006	Mounting Kit 9		5.090.000
3" Wind Curtain		50.100.011	Mounting Kit 1		5.010.000	Mounting Kit 10		5.100.000
Dome Window		20.040.015	Mounting Kit 2		5.020.000	Mounting Kit 15		5.150.000
30mm Extension		15.030.030	Mounting Kit 6		5.060.000	Mounting Kit 16		5.160.000
60mm Extension		15.030.085	M12 Front Lid		20.040.018	Mounting Kit 17		5.170.000
						Mounting Tool		90.000.004

