

QUARTER-TURN 13.5MM LOCK

2452-033250-1627

Complete 90° lock, compact 13.5mm, recessed hexagon 6, assembled

- 13.5mm lock housing
- Compact
- 90°
- Vibration resistant
- Configurable



PRODUCT DESCRIPTION

A complete lock consists of lock housing, nut, insert, washer, screw and rule. Protection class IP65 is obtained by placing an O-ring on the insert and a flat gasket on the lock housing.

This variant that is in the picture is built with a product key, which is resolved together with the product manager.

Lock housing : Zinc, chrome-plated A=20 B=3

Nut : Standard

Lock housing insert: Insex 6

Surface coating: chrome

Mounting : IP 65 Mounted

Rule: steel

H/L measurements: 16.5/27 mm

The locks can be delivered unassembled, preassembled with enclosed rule or in complete assembled condition

Example: Lock housing - chrome-plated A=20, B=3, brass nut, insert Square 6 - chrome-plated, IP65 mounting and rule (fzb) standard for H=16.5 mm L=27 mm gives the following article number: 2452-001250-1627 .

Protection class IP65 is obtained by placing an O-ring on the insert and a flat gasket on the lock housing.

TECHNICAL DATA

Configurable	Yes
Dimension H	16.5 mm
Dimension L	27 mm
Material lock housing	Zinc, chrome
Material rule	Zinc plated steel
Opening angle	90 °

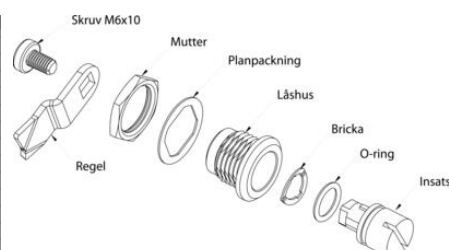
[illegible]

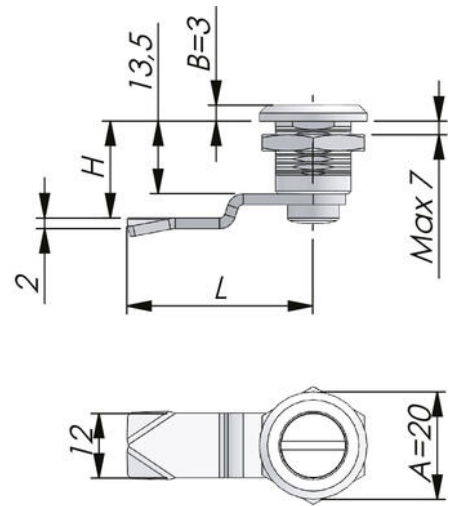

SUMMARY REPORT FOR KOMPETITIF NO-1 (AS) KOMPETITIF 0004													
VERBODEN TOEGANG TOT DEZE DATA (NIEUW GEGADDE)													
AS-NAAM	Lidmaat	# Kwalificatie	# C/A	Finalist	# Kwalificatie	# Kwalificatie	# Kwalificatie	# Rang	GOED	RIJZEN			
2452	Zink, Nikolaas A+22 B+1	2	201	58	Pykman 6	2	Klaas 6	2	1994, Amsterdam	2	200	1000	Dagen regel
2453	Zink, start A+20 B+1	2	102	58	Pykman 6 / 102	8	Start 1	2	1945, Amsterdam				7.5/24
2454	Zink, start A+20 B+1	2	102	58	Pykman 6 / 102	8	Start 1	2	1945, Amsterdam				-0714
2455	Zink, start A+20 B+1	2	102	58	Pykman 6 / 102	8	Start 1	2	1945, Amsterdam				-0717
2456	Zink, start A+20 B+1	2	102	58	Pykman 6 / 102	8	Start 1	2	1945, Amsterdam				7.5/27
2457	Zink, start A+20 B+1	2	102	58	Pykman 6 / 102	8	Start 1	2	1945, Amsterdam				-0730
2458	Zink, start A+20 B+1	2	102	58	Pykman 6 / 102	8	Start 1	2	1945, Amsterdam				7.5/30
2459	Zink, start A+20 B+1	2	102	58	Pykman 6 / 102	8	Start 1	2	1945, Amsterdam				-0934
2460	Zink, start A+20 B+1	2	102	58	Pykman 6 / 102	8	Start 1	2	1945, Amsterdam				9/34
2461	Zink, start A+20 B+1	2	102	58	Pykman 6 / 102	8	Start 1	2	1945, Amsterdam				-1027
2462	Zink, start A+20 B+1	2	102	58	Pykman 6 / 102	8	Start 1	2	1945, Amsterdam				10.5/27
2463	Zink, start A+20 B+1	2	102	58	Pykman 6 / 102	8	Start 1	2	1945, Amsterdam				-1104
2464	Zink, start A+20 B+1	2	102	58	Pykman 6 / 102	8	Start 1	2	1945, Amsterdam				13.0/24
2465	Zink, start A+20 B+1	2	102	58	Pykman 6 / 102	8	Start 1	2	1945, Amsterdam				-1327
2466	Zink, start A+20 B+1	2	102	58	Pykman 6 / 102	8	Start 1	2	1945, Amsterdam				13.5/27
2467	Zink, start A+20 B+1	2	102	58	Pykman 6 / 102	8	Start 1	2	1945, Amsterdam				-1417
2468	Zink, start A+20 B+1	2	102	58	Pykman 6 / 102	8	Start 1	2	1945, Amsterdam				16.5/27
2469	Zink, start A+20 B+1	2	102	58	Pykman 6 / 102	8	Start 1	2	1945, Amsterdam				-1804
2470	Zink, start A+20 B+1	2	102	58	Pykman 6 / 102	8	Start 1	2	1945, Amsterdam				18/24
2471	Zink, start A+20 B+1	2	102	58	Pykman 6 / 102	8	Start 1	2	1945, Amsterdam				-1927
2472	Zink, start A+20 B+1	2	102	58	Pykman 6 / 102	8	Start 1	2	1945, Amsterdam				19.5/24
2473	Zink, start A+20 B+1	2	102	58	Pykman 6 / 102	8	Start 1	2	1945, Amsterdam				-2024
2474	Zink, start A+20 B+1	2	102	58	Pykman 6 / 102	8	Start 1	2	1945, Amsterdam				20/24

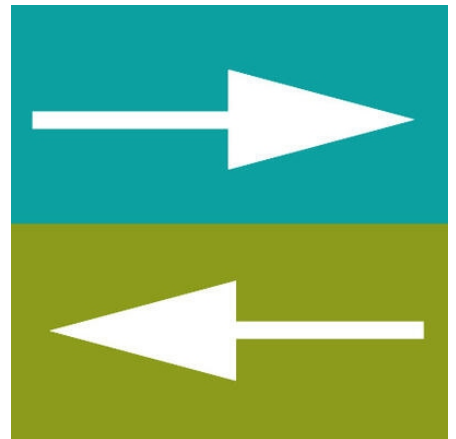



IP65

