

## STAINLESS COMPRESSION LOCK 35MM

243087-11

Compression lock 35mm, Square 10 / M6, Stainless steel 304

- 35mm lock housing
- IP65
- 90°
- Compact and stainless
- 6mm compression



### PRODUCT DESCRIPTION

Stainless compression lock 35 mm. Locks and compresses through a 180° rotation. The first 90° rotation locks the rule, the second 90° rotation compresses the rule 6 mm. This is illustrated in the drawing below.

The lock is delivered assembled, IP65.

Please note that rule is ordered separately. Select rule without allocation.

- Vibration resistant according to DIN EN 61373
- Watertight according to NEMA 4
- Integrated PUR gasket
- Universal left / right

### TECHNICAL DATA

<b>Configurable</b>	No
<b>Material lock housing</b>	Stainless steel AISI 304
<b>Material nut</b>	Stainless steel 303
<b>Opening angle</b>	90 °

 COMBI

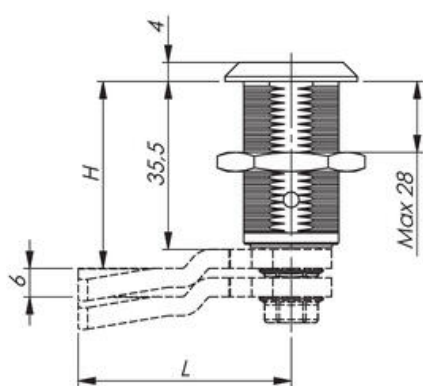
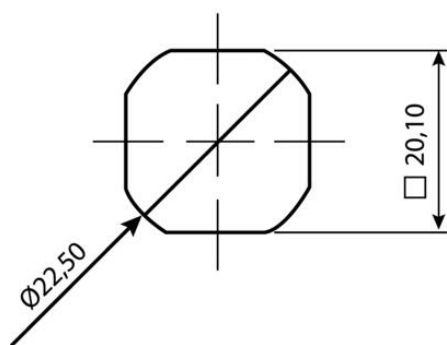

 COMBI

