

MINIMOTOR MCF WORM GEAR MOTOR

MCF2T2-70 B5

230/400V 3 ph 40rpm 4.8 Nm B5 mount

- For clean environments
- IP67 as standard
- Up to 6.4Nm rated torque
- Minimal dirt trap points
- Epoxy coated with no external fan



PRODUCT DESCRIPTION

WORM GEARED MOTOR

White epoxy coating for increased protection against chemicals and harsh working environments.
IP67 rated with no external fan.

MOTOR: Asynchronous three-phase motor with 2 poles, totally Class H winding in accordance with CEI EN 60034-1.

GEAR UNIT: With die-cast aluminium casing. Wheel rim in special bronze 120/160 HB hardness. Worm gear in hardened steel with thread rotating on ball and roller bearings. Output shaft in stainless steel on request

Lubrication with special long-lasting oil. Sealing rings made in special white rubber for high temperatures.
Rated torque from 0,8 to 5 Nm. Version B3 or B5. B5/S left version - B5/D right version.

The standard MCE version is also available with IP67 called MCEF

[Please click here for 2D and 3D drawings](#)

TECHNICAL DATA

| | |
|------------------|-------------|
| Input voltage ac | 230Δ/400Y |
| IP class | IP67 |
| Nominal speed | 40 rpm |
| Nominal torque | 4.8 |
| Output power | 31 W |
| Rated current | 0.30Δ/0.17Y |
| Ratio | 70:1 |

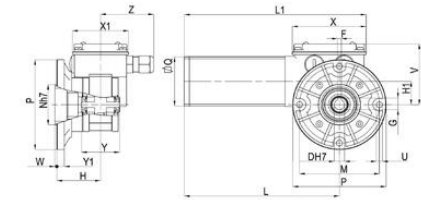

B5/S

| Type | D | F | G | H | H1 | L | L1 | M | N | P | Q | U | V | X | X1 | Y | Y1 | W | Z | Z1 | Max. Weight kg |
|-------|----|---|------|----|----|-----|-----|----|----|-----|----|-----|----|----|----|----|----|---|----|----|-------------------|
| MC722 | 11 | 4 | 12,8 | 48 | 26 | 167 | 196 | 86 | 45 | 100 | 55 | 6,5 | 69 | 80 | 60 | 41 | 8 | 2 | 56 | 40 | 2,400 |

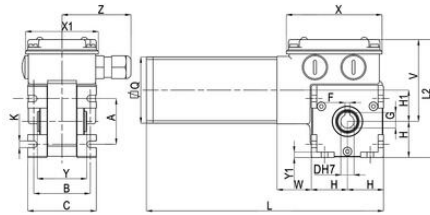

B3

| Type | A | B | C | D | F | G | H | H1 | K | L | L2 | Q | V | X | X1 | Y | Y1 | W | Z | Z1 | Max. Weight kg |
|-------|----|----|----|----|---|------|----|----|-----|-----|----|----|----|----|----|----|-----|----|----|----|-------------------|
| MC722 | 38 | 47 | 58 | 11 | 4 | 12,8 | 30 | 26 | 5,5 | 197 | 99 | 55 | 69 | 80 | 60 | 41 | 4,5 | 28 | 56 | 40 | 2,200 |

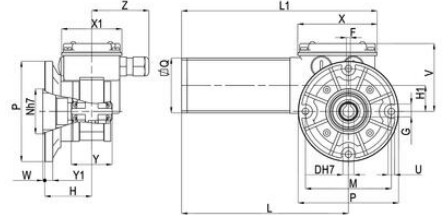

B5/S

| Type | D | F | G | H | H1 | L | L1 | M | N | P | Q | U | V | X | X1 | Y | Y1 | W | Z | Z1 | Max. Weight kg |
|-------|----|---|------|----|----|-----|-----|----|----|-----|----|-----|----|----|----|----|----|---|----|----|-------------------|
| MC722 | 11 | 4 | 12,8 | 48 | 26 | 167 | 196 | 86 | 45 | 100 | 55 | 6,5 | 69 | 80 | 60 | 41 | 8 | 2 | 56 | 40 | 2,400 |

CAD model selection

Electric motors
15.06.2017

Gear motor
15.06.2017

Vorn gearmotors
15.06.2017

Brushless servomotors
15.06.2017

Clean products
15.06.2017

Others

Please see product description above for 2D and 3D drawings

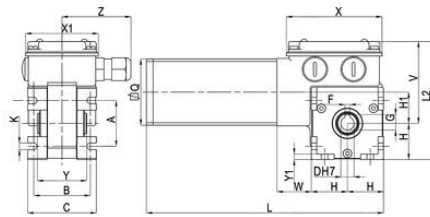

B3

| Type | A | B | C | D | F | G | H | H1 | K | L | L2 | Q | V | X | X1 | Y | Y1 | W | Z | Z1 | Max. Weight kg |
|-------|----|----|----|----|---|------|----|----|-----|-----|----|----|----|----|----|----|-----|----|----|----|-------------------|
| MC722 | 38 | 47 | 58 | 11 | 4 | 12,8 | 30 | 26 | 5,5 | 197 | 99 | 55 | 69 | 80 | 60 | 41 | 4,5 | 28 | 56 | 40 | 2,200 |

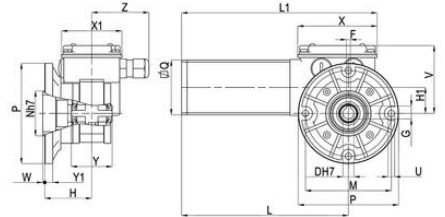

B5/S

| Type | D | F | G | H | H1 | L | L1 | M | N | P | Q | U | V | X | X1 | Y | Y1 | W | Z | Z1 | Max. Weight kg |
|-------|----|---|------|----|----|-----|-----|----|----|-----|----|-----|----|----|----|----|----|---|----|----|-------------------|
| MC722 | 11 | 4 | 12,8 | 48 | 26 | 167 | 196 | 86 | 45 | 100 | 55 | 6,5 | 69 | 80 | 60 | 41 | 8 | 2 | 56 | 40 | 2,400 |

CAD model selection

Electric motors
15.06.2017

Gear motor
15.06.2017

Vorn gearmotors
15.06.2017

Brushless servomotors
15.06.2017

Clean products
15.06.2017

Others

Please see product description above for 2D and 3D drawings