

## MINIMOTOR MCF WORM GEAR MOTOR

MCF2T2-60 B3

230/400V 3 ph 46rpm 4.5 Nm B3 mount

- For clean environments
- IP67 as standard
- Up to 6.4Nm rated torque
- Minimal dirt trap points
- Epoxy coated with no external fan



### PRODUCT DESCRIPTION

#### WORM GEARED MOTOR

White epoxy coating for increased protection against chemicals and harsh working environments.  
IP67 rated with no external fan.

MOTOR: Asynchronous three-phase motor with 2 poles, totally Class H winding in accordance with CEI EN 60034-1.

GEAR UNIT: With die-cast aluminium casing. Wheel rim in special bronze 120/160 HB hardness. Worm gear in hardened steel with thread rotating on ball and roller bearings. Output shaft in stainless steel on request

Lubrication with special long-lasting oil. Sealing rings made in special white rubber for high temperatures.  
Rated torque from 0,8 to 5 Nm. Version B3 or B5. B5/S left version - B5/D right version.

The standard MCE version is also available with IP67 called MCEF

[Please click here for 2D and 3D drawings](#)

### TECHNICAL DATA

Input voltage ac	230Δ/400Y
IP class	IP67
Nominal speed	46 rpm
Nominal torque	4.5
Output power	31 W
Rated current	0.30Δ/0.17Y
Ratio	60:1

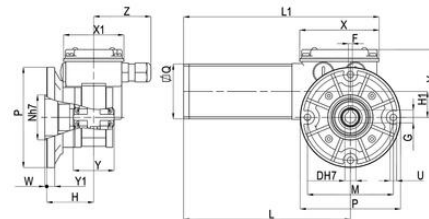
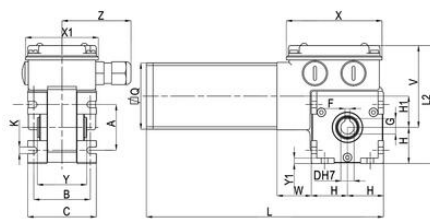
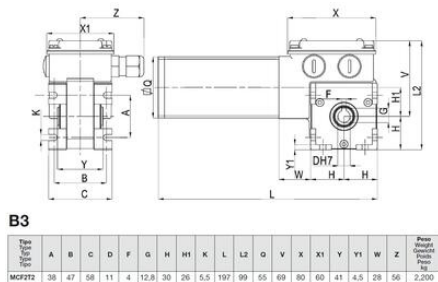

CMC model selection

Electric motors

Gear motor

Worm gear motors

Brushless servomotors

Clean products

Others

Please see product description above for 2D and 3D drawings

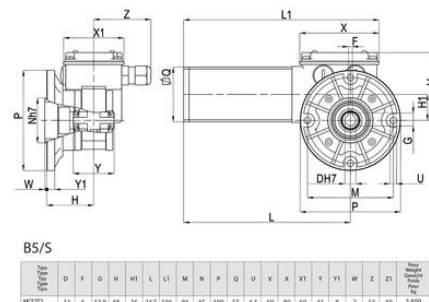
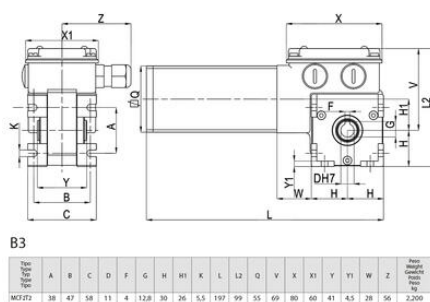

CMC model selection

Electric motors

Gear motor

Worm gear motors

Brushless servomotors

Clean products

Others

Please see product description above for 2D and 3D drawings